

画地出来形面積計算書

世界測地系

現場名：北部第三地区

地番名： 166-1_1

点名	Xn	Yn	距離	方向角	Yn+1-Yn-1	Xn × (Yn+1-Yn-1)
166B.96	47336.547	-69402.466	3.157	185° 52' 23"	-1.422	-67312.569834
166B.82	47333.407	-69402.789	26.106	92° 58' 15"	25.748	1218740.563436
166B.105	47332.054	-69376.718	3.674	342° 13' 15"	24.949	1180887.415246
166B.104	47335.553	-69377.840	0.521	334° 39' 51"	-1.345	-63666.318785
166B.103	47336.024	-69378.063	0.522	319° 44' 39"	-0.560	-26508.173440
166B.102	47336.422	-69378.400	0.522	304° 41' 43"	-0.766	-36259.699252
166B.101	47336.719	-69378.829	0.522	289° 49' 25"	-0.920	-43549.781480
166B.100	47336.896	-69379.320	0.522	274° 43' 38"	-1.011	-47857.601856
166B.99	47336.939	-69379.840	20.371	267° 15' 34"	-20.868	-987827.243052
166B.98	47335.965	-69400.188	1.185	275° 48' 42"	-21.527	-1019001.318555
166B.97	47336.085	-69401.367	1.192	292° 48' 04"	-2.278	-107831.601630

倍面積合計	-186.329202
1/2	93.1646010

合計面積	93.1646010
------	------------

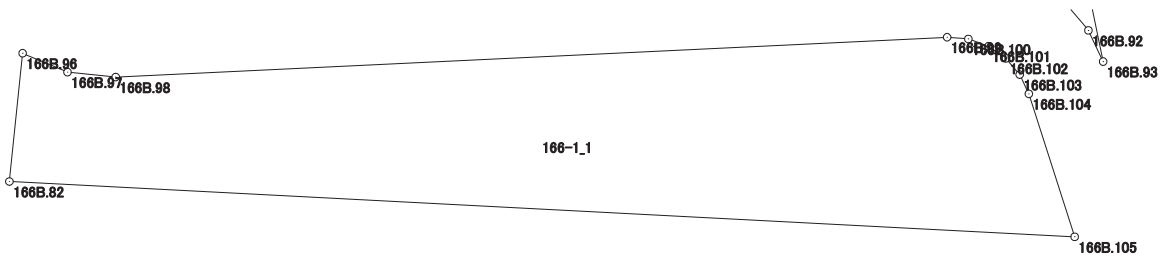

画地出来形面積計算書

世界測地系

現場名：北部第三地区

地番名： 166-1_2

点名	Xn	Yn	距離	方向角	Yn+1-Yn-1	Xn × (Yn+1-Yn-1)
166B.30	47339.876	-69402.124	0.749	185° 49' 29"	-25.188	-1192396.796688
166B.52	47339.131	-69402.200	0.596	146° 50' 35"	0.250	11834.782750
166B.53	47338.632	-69401.874	0.592	129° 55' 46"	0.780	36924.132960
166B.85	47338.252	-69401.420	0.592	112° 45' 14"	1.000	47338.252000
166B.86	47338.023	-69400.874	0.594	95° 47' 49"	1.137	53823.332151
166B.87	47337.963	-69400.283	20.370	87° 15' 44"	20.938	991162.269294
166B.88	47338.936	-69379.936	1.044	94° 43' 38"	21.387	1012437.824232
166B.89	47338.850	-69378.896	1.043	109° 43' 13"	2.022	95719.154700
166B.90	47338.498	-69377.914	1.044	124° 44' 25"	1.840	87102.836320
166B.91	47337.903	-69377.056	1.043	139° 44' 39"	1.532	72521.667396
166B.92	47337.107	-69376.382	0.845	154° 42' 31"	1.035	48993.905745
166B.93	47336.343	-69376.021	4.840	348° 11' 02"	-0.630	-29821.896090
166B.29	47341.080	-69377.012	25.141	267° 15' 18"	-26.103	-1235744.211240

倍面積合計	-104.746470
1/2	52.3732350

合計面積	52.3732350
------	------------

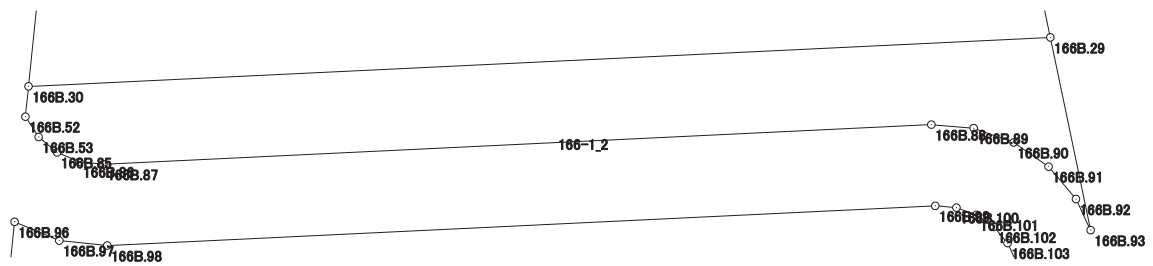

画地出来形面積計算書

世界測地系

現場名：北部第三地区

地番名： 166-1_3

点名	Xn	Yn	距離	方向角	Yn+1-Yn-1	Xn × (Yn+1-Yn-1)
166B. 14	47429. 386	-69378. 399	17. 108	204° 51' 48"	-8. 392	-398027. 407312
166B. 15	47413. 864	-69385. 592	23. 568	196° 40' 24"	-13. 955	-661660. 472120
166B. 1	47391. 287	-69392. 354	23. 836	193° 01' 56"	-12. 137	-575188. 050319
166B. 2	47368. 065	-69397. 729	23. 837	189° 26' 53"	-9. 288	-439954. 587720
166B. 3	47344. 551	-69401. 642	4. 700	185° 53' 11"	-4. 395	-208079. 301645
166B. 30	47339. 876	-69402. 124	25. 141	87° 15' 18"	24. 630	1165981. 145880
166B. 29	47341. 080	-69377. 012	19. 685	348° 10' 51"	21. 080	997949. 966400
K. 155	47360. 348	-69381. 044	9. 215	346° 20' 27"	-6. 208	-294013. 040384
K. 154	47369. 302	-69383. 220	34. 283	358° 55' 07"	-2. 823	-133723. 539546
K. 153	47403. 579	-69383. 867	4. 426	42° 20' 39"	2. 334	110639. 953386
K. 152	47406. 850	-69380. 886	10. 039	2° 34' 50"	3. 433	162747. 716050
K. 151	47416. 879	-69380. 434	3. 404	71° 49' 14"	3. 686	174778. 615994
K. 150	47417. 941	-69377. 200	11. 508	354° 01' 10"	2. 035	96495. 509935

倍面積合計	-2053. 491401
1/2	1026. 7457005

合計面積	1026. 7457005
------	---------------

