

45街区 画地出来形確認図 (10293.16m²)

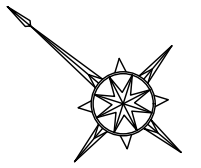

S=1:500
(1/2)

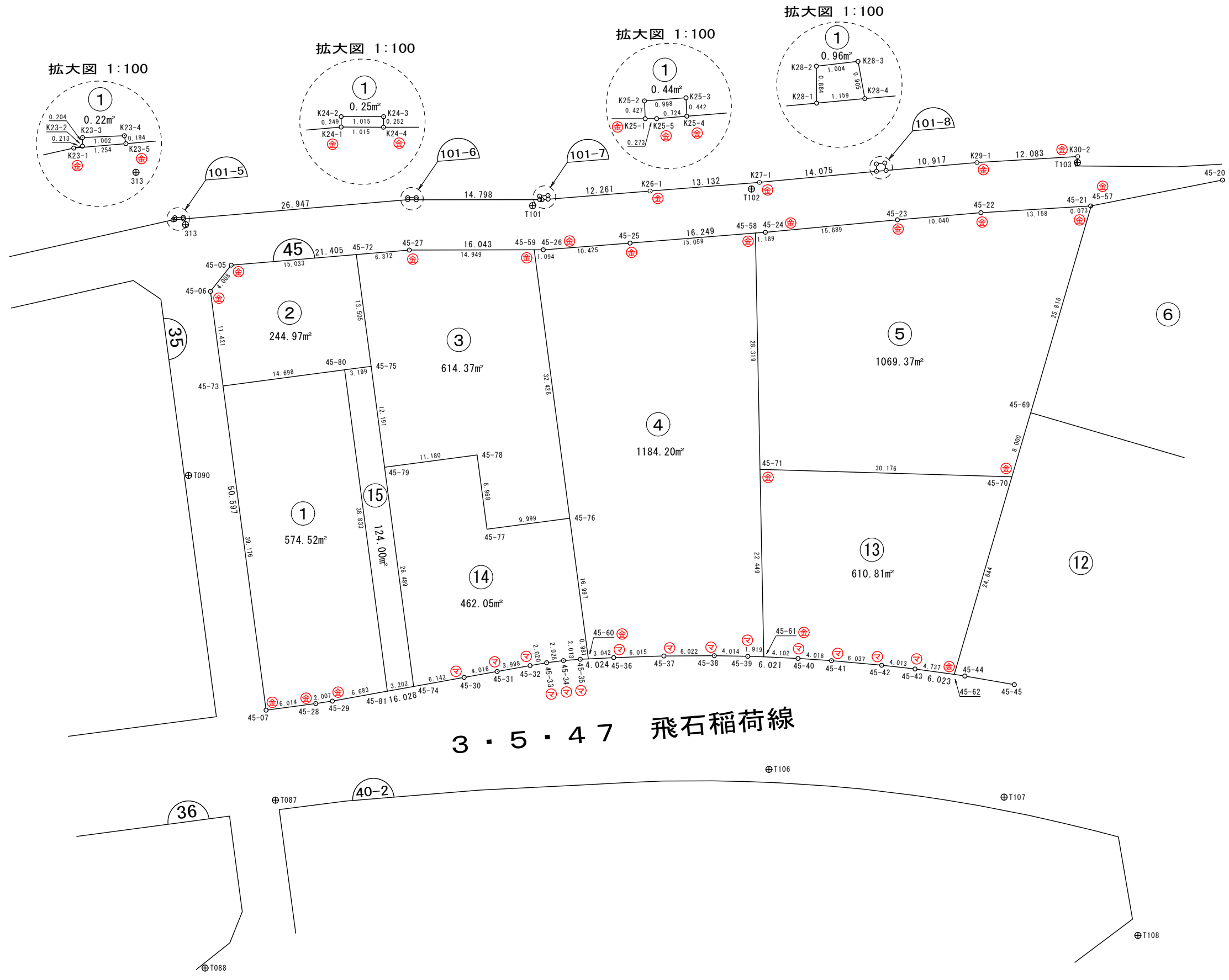

拡大図 1:100

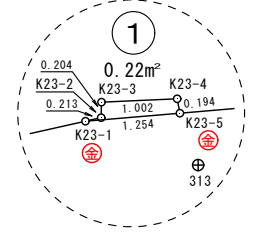

拡大図 1:100

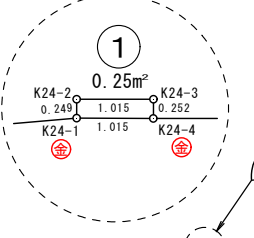

拡大図 1:100

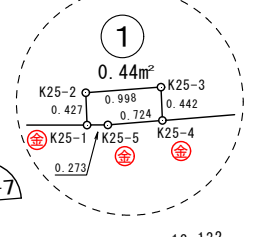

拡大図 1:100

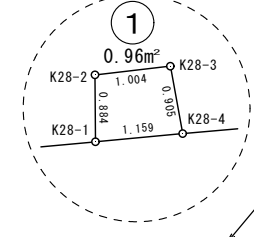

3・5・47 飛石稻荷線

凡 例	
事 項	記 号
金属プレート	⊕
コンクリート杭	⊙
金属釘	⊗
合成樹脂杭	⊕
マーキング	⊗

45街区 画地出来形確認図 (10293.16m²)

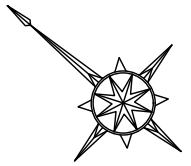

S=1:500

(2/2)

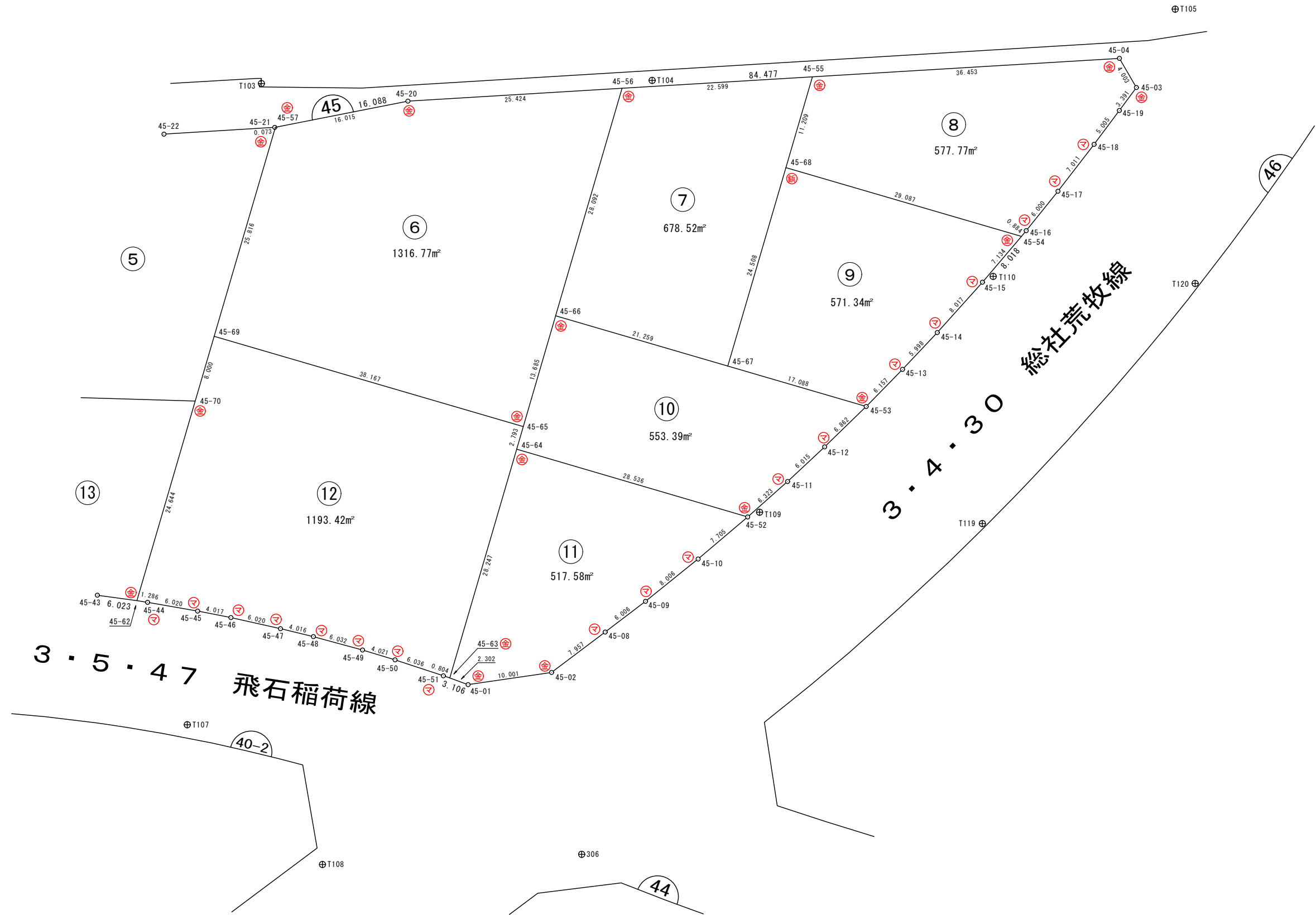

凡 例	
事 項	記 号
金属プレート	⊕
コンクリート杭	⊖
金属釘	⊗
合成樹脂杭	⊙
マーキング	⊚

画地面積(座標法)計算簿

画地番号：45-01

点名	Xn	Yn	距離	方向角	X _{n+1} -X _{n-1}	Y _{n+1} -Y _{n-1}	X _n *(Y _{n+1} -Y _{n-1})	Y _n *(X _{n+1} -X _{n-1})
45-80	47766.096	-70795.561	14.698	312° 26' 28"	38.578	15.358	733591.702368	-2731151.152258
45-73	47776.015	-70806.408	39.176	222° 26' 19"	-18.993	-37.283	-1781233.167245	1344826.107144
45-07	47747.103	-70832.844	6.014	132° 27' 34"	-32.972	-21.999	-1050388.518897	2335500.532368
45-28	47743.043	-70828.407	2.007	131° 18' 15"	-5.385	5.945	283832.390635	381410.971695
45-29	47741.718	-70826.899	6.683	129° 49' 43"	-5.606	6.641	317052.749238	397055.595794
45-81	47737.437	-70821.766	38.833	42° 26' 20"	24.378	31.338	1495995.800706	-1726493.011548
							倍面積	-1149.043195
							面積	574.5215975
							地積	574.52

画地面積(座標法)計算簿

画地番号：45-02

点名	Xn	Yn	距離	方向角	X _{n+1} -X _{n-1}	Y _{n+1} -Y _{n-1}	X _n *(Y _{n+1} -Y _{n-1})	Y _n *(X _{n+1} -X _{n-1})
45-73	47776.015	-70806.408	14.698	132° 26' 28"	-18.348	3.140	150016.687100	1299155.973984
45-80	47766.096	-70795.561	3.199	132° 33' 20"	-12.083	13.204	630703.531584	855422.763563
45-75	47763.932	-70793.204	13.505	42° 26' 04"	7.804	11.470	547852.300040	-552470.164016
45-72	47773.900	-70784.091	15.033	315° 08' 44"	20.625	-1.490	-71183.111000	-1459921.876875
45-05	47784.557	-70794.694	4.008	268° 23' 05"	10.544	-14.610	-698132.377770	-746459.253536
45-06	47784.444	-70798.701	11.421	222° 26' 17"	-8.542	-11.714	-559746.977016	604762.503942
							倍面積	-489.947062
							面積	244.9735310
							地積	244.97

画地面積(座標法)計算簿

画地番号：45-03

点名	X _n	Y _n	距離	方向角	X _{n+1} -X _{n-1}	Y _{n+1} -Y _{n-1}	X _n *(Y _{n+1} -Y _{n-1})	Y _n *(X _{n+1} -X _{n-1})
45-76	47734.019	-70791.854	9.999	312° 26' 48"	-17.180	-29.266	-1396983.800054	1216204.051720
45-77	47740.768	-70799.233	8.968	42° 25' 44"	13.369	-1.328	-63399.739904	-946514.945977
45-78	47747.388	-70793.182	11.180	312° 27' 19"	14.167	-2.198	-104948.758824	-1002927.009394
45-79	47754.935	-70801.431	12.191	42° 26' 25"	16.544	-0.022	-1050.608570	-1171338.874464
45-75	47763.932	-70793.204	13.505	42° 26' 04"	18.965	17.340	828226.580880	-1342593.113860
45-72	47773.900	-70784.091	6.372	135° 08' 24"	5.451	13.608	650107.231200	-385844.080041
45-27	47769.383	-70779.596	14.949	139° 54' 02"	-15.952	14.124	674694.765492	1129076.115392
45-59	47757.948	-70769.967	32.428	222° 26' 53"	-35.364	-12.258	-585416.926584	2502709.112988
							倍面積	1228.743636
							面積	614.3718180
							地積	614.37

画地面積(座標法)計算簿

画地番号：45-04

点名	Xn	Yn	距離	方向角	X _{n+1} -X _{n-1}	Y _{n+1} -Y _{n-1}	X _n *(Y _{n+1} -Y _{n-1})	Y _n *(X _{n+1} -X _{n-1})
45-61	47705.550	-70789.629	1.919	321° 36' 05"	-13.270	-18.095	-863231.927250	939378.376830
45-39	47707.054	-70790.821	4.014	321° 05' 50"	4.628	-3.713	-177136.291502	-327619.919588
45-38	47710.178	-70793.342	6.022	319° 40' 01"	7.715	-6.419	-306251.632582	-546170.633530
45-37	47714.769	-70797.240	6.015	318° 06' 48"	9.069	-7.914	-377614.681866	-642060.169560
45-36	47719.247	-70801.256	3.042	317° 07' 51"	6.708	-6.086	-290419.337242	-474934.825248
45-60	47721.477	-70803.326	16.997	42° 26' 55"	14.772	9.402	448677.326754	-1045906.731672
45-76	47734.019	-70791.854	32.428	42° 26' 53"	36.471	33.359	1592359.139821	-2581849.707234
45-59	47757.948	-70769.967	1.094	140° 06' 50"	23.089	22.589	1078804.287372	-1634007.768063
45-26	47757.108	-70769.265	10.425	135° 31' 57"	-8.280	8.005	382295.649540	585969.514200
45-25	47749.668	-70761.962	15.059	135° 24' 22"	-18.164	17.876	853573.065168	1285320.277768
45-58	47738.944	-70751.389	28.319	228° 53' 24"	-29.344	-10.764	-513861.993216	2076128.758816
45-71	47720.324	-70772.726	22.449	228° 50' 42"	-33.394	-38.240	-1824825.189760	2363384.412044
							倍面積	2368.415237
							面積	1184.2076185
							地積	1184.20

画地面積(座標法)計算簿

画地番号：45-05

点名	Xn	Yn	距離	方向角	X _{n+1} -X _{n-1}	Y _{n+1} -Y _{n-1}	X _n *(Y _{n+1} -Y _{n-1})	Y _n *(X _{n+1} -X _{n-1})
45-69	47699.856	-70746.695	8.000	246° 19' 19"	-13.579	-30.971	-1477312.240176	960669.371405
45-70	47696.643	-70754.022	30.176	321° 41' 50"	20.468	-26.031	-1241591.313933	-1448193.322296
45-71	47720.324	-70772.726	28.319	48° 53' 24"	42.301	2.633	125647.613092	-2993757.082526
45-58	47738.944	-70751.389	1.189	135° 57' 13"	17.765	22.164	1058085.954816	-1256898.425585
45-24	47738.089	-70750.562	15.889	134° 36' 36"	-12.014	12.139	579492.662371	849997.251868
45-23	47726.930	-70739.250	10.040	135° 06' 47"	-18.273	18.398	878080.058140	1292618.315250
45-22	47719.816	-70732.164	13.158	136° 29' 14"	-16.657	16.146	770484.149136	1178185.655748
45-21	47710.273	-70723.104	0.073	133° 53' 54"	-9.594	9.113	434783.717849	678517.459776
45-57	47710.222	-70723.051	25.816	246° 19' 35"	-10.417	-23.591	-1125531.847202	736722.022267
							倍面積	2138.754093
							面積	1069.3770465
							地積	1069.37

画地面積(座標法)計算簿

画地番号：45-06

点名	Xn	Yn	距離	方向角	X _{n+1} -X _{n-1}	Y _{n+1} -Y _{n-1}	X _n *(Y _{n+1} -Y _{n-1})	Y _n *(X _{n+1} -X _{n-1})
45-69	47699.856	-70746.695	38.167	156° 17' 14"	-45.311	-8.295	-395670.305520	3205603.497145
45-65	47664.911	-70731.346	13.685	66° 16' 35"	-29.439	27.878	1328802.388858	2082260.094894
45-66	47670.417	-70718.817	28.092	66° 17' 11"	16.804	38.250	1823393.450250	-1188359.000868
45-56	47681.715	-70693.096	25.424	316° 33' 14"	29.757	8.237	392754.286455	-2103614.457672
45-20	47700.174	-70710.580	16.015	308° 51' 31"	28.507	-29.955	-1428858.712170	-2015746.504060
45-57	47710.222	-70723.051	25.816	246° 19' 35"	-0.318	-36.115	-1723054.667530	22489.930218
							倍面積	-2633.559657
							面積	1316.7798285
							地積	1316.77

画地面積(座標法)計算簿

画地番号：45-07

点名	Xn	Yn	距離	方向角	X _{n+1} -X _{n-1}	Y _{n+1} -Y _{n-1}	X _n *(Y _{n+1} -Y _{n-1})	Y _n *(X _{n+1} -X _{n-1})
45-67	47650.953	-70710.267	24.508	66° 18' 56"	-9.619	30.994	1476893.637282	680162.058273
45-68	47660.798	-70687.823	11.209	66° 17' 53"	14.351	32.708	1558889.380984	-1014440.947873
45-55	47665.304	-70677.559	22.599	316° 34' 01"	20.917	-5.273	-251339.147992	-1478362.501603
45-56	47681.715	-70693.096	28.092	246° 17' 11"	5.113	-41.258	-1967252.197470	-361453.799848
45-66	47670.417	-70718.817	21.259	156° 17' 08"	-30.762	-17.171	-818548.730307	2175452.248554
							倍面積	-1357.057503
							面積	678.5287515
							地積	678.52

画地面積(座標法)計算簿

画地番号：45-08

点名	X _n	Y _n	距離	方向角	X _{n+1} -X _{n-1}	Y _{n+1} -Y _{n-1}	X _n *(Y _{n+1} -Y _{n-1})	Y _n *(X _{n+1} -X _{n-1})
45-54	47634.169	-70676.119	29.087	336° 16' 25"	26.624	-12.588	-599618.919372	-1881680.992256
45-68	47660.798	-70687.823	11.209	66° 17' 53"	31.135	-1.440	-68631.549120	-2200865.369105
45-55	47665.304	-70677.559	36.453	136° 33' 14"	-21.960	35.332	1684110.520928	1552079.195640
45-04	47638.838	-70652.491	4.003	199° 48' 39"	-30.233	23.711	1129564.487818	2136036.760403
45-03	47635.071	-70653.848	3.391	266° 41' 14"	-3.963	-4.743	-225933.141753	280001.199624
45-19	47634.875	-70657.234	5.005	266° 42' 46"	-0.483	-8.383	-399323.157125	34127.444022
45-18	47634.588	-70662.231	7.011	267° 35' 19"	-0.582	-12.002	-571710.325176	41125.418442
45-17	47634.293	-70669.236	6.000	268° 51' 49"	-0.414	-13.004	-619436.346172	29257.063704
45-16	47634.174	-70675.235	0.884	269° 40' 33"	-0.124	-6.883	-327866.019642	8763.729140
							倍面積	1155.550386
							面積	577.7751930
							地積	577.77

画地面積(座標法)計算簿

画地番号：45-09

点名	X _n	Y _n	距離	方向角	X _{n+1} -X _{n-1}	Y _{n+1} -Y _{n-1}	X _n *(Y _{n+1} -Y _{n-1})	Y _n *(X _{n+1} -X _{n-1})
45-68	47660.798	-70687.823	24.508	246° 18' 56"	16.784	-34.148	-1627520.930104	-1186424.421232
45-67	47650.953	-70710.267	17.088	156° 16' 50"	-25.490	-15.570	-741925.338210	1802404.705830
45-53	47635.308	-70703.393	6.157	94° 25' 28"	-16.120	13.013	619878.263004	1139738.695160
45-13	47634.833	-70697.254	5.998	93° 20' 08"	-0.824	12.127	577667.619791	58254.537296
45-14	47634.484	-70691.266	8.017	91° 55' 48"	-0.619	14.001	666930.410484	43757.893654
45-15	47634.214	-70683.253	7.134	90° 21' 41"	-0.315	15.147	721515.439458	22265.224695
45-54	47634.169	-70676.119	29.087	336° 16' 25"	26.584	-4.570	-217688.152330	-1878853.947496
							倍面積	-1142.687907
							面積	571.3439535
							地積	571.34

画地面積(座標法)計算簿

画地番号：45-10

点名	X _n	Y _n	距離	方向角	X _{n+1} -X _{n-1}	Y _{n+1} -Y _{n-1}	X _n *(Y _{n+1} -Y _{n-1})	Y _n *(X _{n+1} -X _{n-1})
45-52	47637.652	-70722.448	28.536	336° 19' 52"	27.056	-17.712	-843758.092224	-1913466.553088
45-64	47663.788	-70733.904	2.793	66° 17' 52"	27.259	-8.898	-424112.385624	-1928135.489136
45-65	47664.911	-70731.346	13.685	66° 16' 35"	6.629	15.087	719120.512257	-468878.092634
45-66	47670.417	-70718.817	21.259	156° 17' 08"	-13.958	21.079	1004844.719943	987093.247686
45-67	47650.953	-70710.267	17.088	156° 16' 50"	-35.109	15.424	734968.299072	2482566.764103
45-53	47635.308	-70703.393	6.862	275° 47' 13"	-14.953	0.046	2191.224168	1057227.835529
45-12	47636.000	-70710.221	6.015	276° 59' 21"	1.424	-12.799	-609693.164000	-100691.354704
45-11	47636.732	-70716.192	6.323	278° 21' 57"	1.652	-12.227	-582454.322164	-116823.149184
							倍面積	1106.791428
							面積	553.3957140
							地積	553.39

画地面積(座標法)計算簿

画地番号：45-11

点名	Xn	Yn	距離	方向角	X _{n+1} -X _{n-1}	Y _{n+1} -Y _{n-1}	X _n *(Y _{n+1} -Y _{n-1})	Y _n *(X _{n+1} -X _{n-1})
45-63	47652.427	-70759.766	28.247	66° 17' 04"	13.525	25.076	1194932.259452	-957025.835150
45-64	47663.788	-70733.904	28.536	156° 19' 52"	-14.775	37.318	1778717.240584	1045093.431600
45-52	47637.652	-70722.448	7.705	279° 41' 23"	-24.839	3.860	183881.336720	1756674.885872
45-10	47638.949	-70730.044	8.006	281° 08' 55"	2.845	-15.451	-736069.400999	-201226.975180
45-09	47640.497	-70737.899	6.006	282° 45' 16"	2.874	-13.713	-653294.135361	-203300.721726
45-08	47641.823	-70743.757	7.957	282° 59' 31"	3.115	-13.612	-648500.494676	-220366.803055
45-02	47643.612	-70751.511	10.001	311° 41' 04"	8.440	-15.223	-725278.705476	-597142.752840
45-01	47650.263	-70758.980	2.302	340° 02' 17"	8.815	-8.255	-393352.921065	-623740.408700
							倍面積	1035.179179
							面積	517.5895895
							地積	517.58

画地面積(座標法)計算簿

画地番号：45-12

点名	Xn	Yn	距離	方向角	X _{n+1} -X _{n-1}	Y _{n+1} -Y _{n-1}	X _n *(Y _{n+1} -Y _{n-1})	Y _n *(X _{n+1} -X _{n-1})
45-65	47664.911	-70731.346	38.167	336° 17' 14"	36.068	-12.791	-609681.876601	-2551138.187528
45-69	47699.856	-70746.695	8.000	246° 19' 19"	31.732	-22.676	-1081641.934656	-2244934.125740
45-70	47696.643	-70754.022	24.644	246° 16' 44"	-13.127	-29.889	-1425604.962627	928788.046794
45-62	47686.729	-70776.584	1.286	149° 01' 43"	-11.017	-21.900	-1044339.365100	779745.625928
45-44	47685.626	-70775.922	6.020	149° 51' 43"	-6.310	3.685	175721.531810	446596.067820
45-45	47680.419	-70772.899	4.017	151° 05' 37"	-8.724	4.965	236733.280335	617422.770876
45-46	47676.902	-70770.957	6.020	152° 34' 31"	-8.861	4.715	224796.592930	627101.449977
45-47	47671.558	-70768.184	4.016	153° 39' 30"	-8.943	4.555	217143.946690	632879.869512
45-48	47667.959	-70766.402	6.032	155° 15' 27"	-9.078	4.307	205305.899413	642417.397356
45-49	47662.480	-70763.877	4.021	156° 49' 12"	-9.176	4.108	195797.467840	649329.335352
45-50	47658.783	-70762.294	6.036	158° 14' 15"	-9.303	3.821	182104.209843	658301.621082
45-51	47653.177	-70760.056	0.804	158° 51' 37"	-6.356	2.528	120467.231456	449750.915936
45-63	47652.427	-70759.766	28.247	66° 17' 04"	10.611	26.152	1246206.270904	-750831.877026
45-64	47663.788	-70733.904	2.793	66° 17' 52"	12.484	28.420	1354604.854960	-883042.057536
							倍面積	-2386.852803
							面積	1193.4264015
							地積	1193.42

画地面積(座標法)計算簿

画地番号：45-13

点名	X _n	Y _n	距離	方向角	X _{n+1} -X _{n-1}	Y _{n+1} -Y _{n-1}	X _n *(Y _{n+1} -Y _{n-1})	Y _n *(X _{n+1} -X _{n-1})
45-62	47686.729	-70776.584	4.737	327° 49' 22"	-5.904	-25.085	-1196221.596965	417864.951936
45-43	47690.739	-70779.107	4.013	326° 22' 10"	7.352	-4.746	-226340.247294	-520367.994664
45-42	47694.081	-70781.330	6.037	325° 11' 10"	8.299	-5.670	-270425.439270	-587414.257670
45-41	47699.038	-70784.777	4.018	323° 48' 21"	8.200	-5.820	-277608.401160	-580435.171400
45-40	47702.281	-70787.150	4.102	322° 49' 32"	6.512	-4.852	-231451.467412	-460965.920800
45-61	47705.550	-70789.629	22.449	48° 50' 42"	18.043	14.424	688104.853200	-1277257.276047
45-71	47720.324	-70772.726	30.176	141° 41' 50"	-8.907	35.607	1699177.576668	630372.670482
45-70	47696.643	-70754.022	24.644	246° 16' 44"	-33.595	-3.858	-184013.648694	2376981.369090
							倍面積	1221.629073
							面積	610.8145365
							地積	610.81

画地面積(座標法)計算簿

画地番号：45-14

点名	Xn	Yn	距離	方向角	X _{n+1} -X _{n-1}	Y _{n+1} -Y _{n-1}	X _n *(Y _{n+1} -Y _{n-1})	Y _n *(X _{n+1} -X _{n-1})
45-79	47754.935	-70801.431	26.489	222° 26' 20"	-12.002	-26.124	-1247549.921940	849758.774862
45-74	47735.386	-70819.306	6.142	129° 49' 42"	-23.483	-13.158	-628102.208988	1663049.762798
45-30	47731.452	-70814.589	4.016	129° 46' 02"	-6.503	7.804	372496.251408	460507.272267
45-31	47728.883	-70811.502	3.998	129° 55' 03"	-5.135	6.154	293723.545982	363617.062770
45-32	47726.317	-70808.435	2.020	130° 18' 11"	-3.873	4.608	219922.868736	274241.068755
45-33	47725.010	-70806.894	2.028	132° 42' 11"	-2.683	3.032	144702.230320	189974.896602
45-34	47723.634	-70805.403	2.013	135° 32' 36"	-2.813	2.901	138446.262234	199175.598639
45-35	47722.197	-70803.993	0.981	137° 11' 18"	-2.157	2.077	99119.003169	152724.212901
45-60	47721.477	-70803.326	16.997	42° 26' 55"	11.822	12.139	579291.009303	-837036.919972
45-76	47734.019	-70791.854	9.999	312° 26' 48"	19.291	4.093	195375.339767	-1365645.655514
45-77	47740.768	-70799.233	8.968	42° 25' 44"	13.369	-1.328	-63399.739904	-946514.945977
45-78	47747.388	-70793.182	11.180	312° 27' 19"	14.167	-2.198	-104948.758824	-1002927.009394
							倍面積	-924.118737
							面積	462.0593685
							地積	462.05

画地面積(座標法)計算簿

画地番号：45-15

点名	Xn	Yn	距離	方向角	X _{n+1} -X _{n-1}	Y _{n+1} -Y _{n-1}	X _n *(Y _{n+1} -Y _{n-1})	Y _n *(X _{n+1} -X _{n-1})
45-75	47763.932	-70793.204	3.199	312° 33' 20"	11.161	5.870	280374.280840	-790122.949844
45-80	47766.096	-70795.561	38.833	222° 26' 20"	-26.495	-28.562	-1364295.233952	1875728.388695
45-81	47737.437	-70821.766	3.202	129° 49' 10"	-30.710	-23.745	-1133525.441565	2174936.433860
45-74	47735.386	-70819.306	26.489	42° 26' 20"	17.498	20.335	970699.074310	-1239196.216388
45-79	47754.935	-70801.431	12.191	42° 26' 25"	28.546	26.102	1246499.313370	-2021097.649326
							倍面積	-248.006997
							面積	124.0034985
							地積	124.00