

# 56街区 画地出来形確認図 (7325.07㎡)

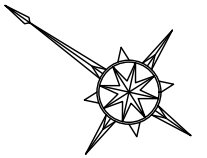

S=1:500

拡大図 1/50

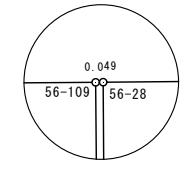

拡大図 1/50

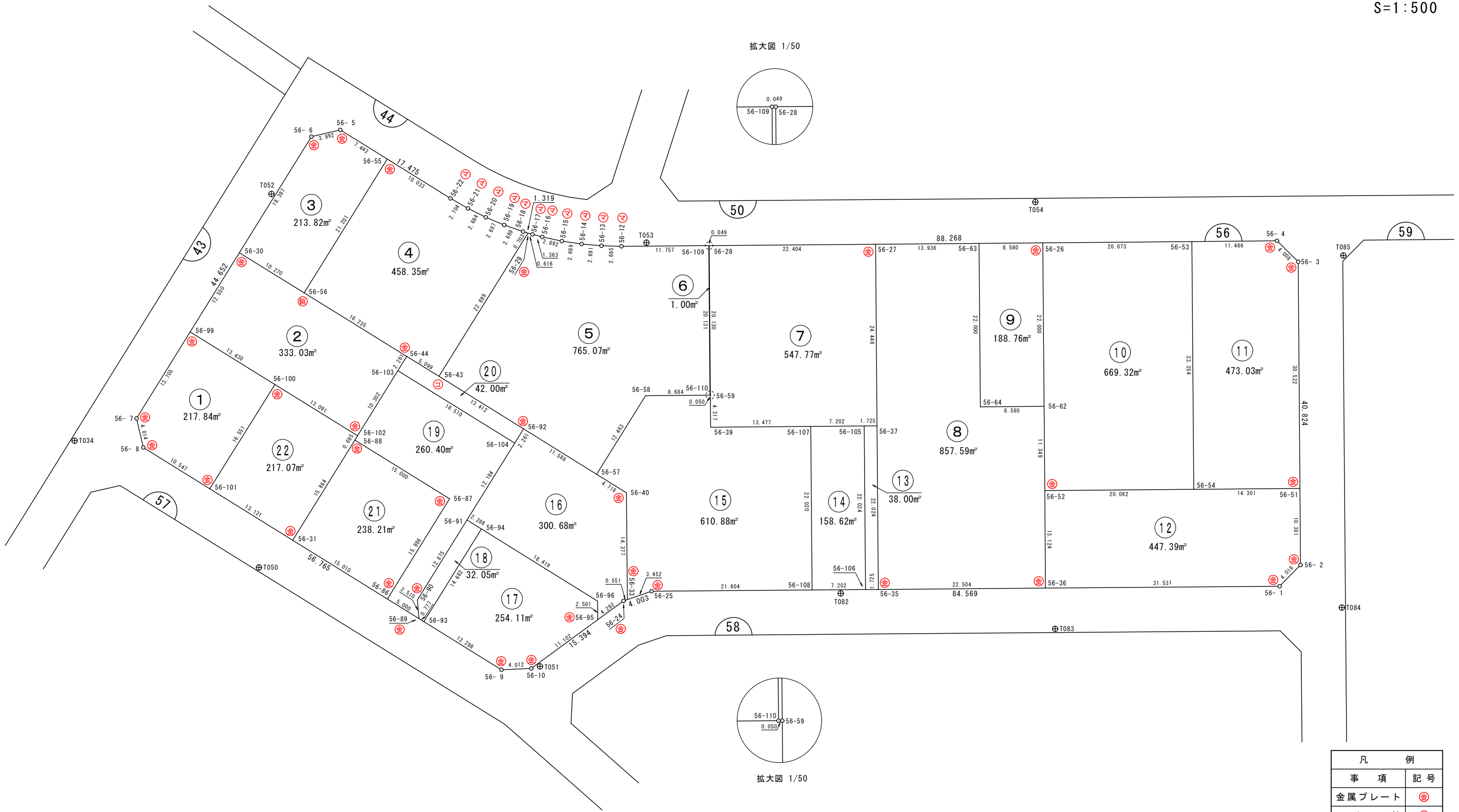
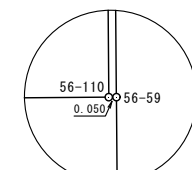

凡 例	
事 項	記 号
金属プレート	⊕
コンクリート杭	⊖
金属 釘	⊙
合成樹脂杭	⊗
マーキング	⊚

## 画地面積(座標法)計算簿

画地番号：56- 1

点名	Xn	Yn	距離	方向角	X <sub>n+1</sub> -X <sub>n-1</sub>	Y <sub>n+1</sub> -Y <sub>n-1</sub>	X <sub>n</sub> *(Y <sub>n+1</sub> -Y <sub>n-1</sub> )	Y <sub>n</sub> *(X <sub>n+1</sub> -X <sub>n-1</sub> )
56-99	47584.587	-70830.863	13.705	266° 49' 31"	12.651	-14.431	-686693.174997	-896081.247813
56- 7	47583.828	-70844.547	4.014	221° 49' 45"	-3.750	-16.361	-778519.009908	265667.051250
56- 8	47580.837	-70847.224	10.547	176° 51' 12"	-13.523	-2.098	-99824.596026	958067.010152
56-101	47570.305	-70846.645	16.551	86° 58' 48"	-9.660	17.108	813832.777940	684378.590700
56-100	47571.177	-70830.116	13.430	356° 48' 42"	14.282	15.782	750768.315414	-1011595.716712
							倍面積	-435.687577
							面積	217.8437885
							地積	217.84

## 画地面積(座標法)計算簿

画地番号：56- 2

点名	Xn	Yn	距離	方向角	X <sub>n+1</sub> -X <sub>n-1</sub>	Y <sub>n+1</sub> -Y <sub>n-1</sub>	X <sub>n</sub> *(Y <sub>n+1</sub> -Y <sub>n-1</sub> )	Y <sub>n</sub> *(X <sub>n+1</sub> -X <sub>n-1</sub> )
56-30	47585.275	-70818.331	12.550	266° 51' 28"	9.566	-13.114	-624033.296350	-677448.154346
56-99	47584.587	-70830.863	13.430	176° 48' 42"	-14.098	-11.785	-560784.357795	998573.506574
56-100	47571.177	-70830.116	13.091	176° 47' 25"	-26.481	1.480	70405.341960	1875652.301796
56-102	47558.106	-70829.383	10.302	86° 47' 02"	-12.493	11.019	524042.770014	884871.481819
56-103	47558.684	-70819.097	2.261	86° 46' 51"	0.705	12.544	596576.132096	-49927.463385
56-44	47558.811	-70816.839	16.235	356° 47' 13"	16.337	1.348	64109.277228	-1156934.698743
56-56	47575.021	-70817.749	10.270	356° 45' 05"	26.464	-1.492	-70981.931332	-1874120.909536
							倍面積	-666.064179
							面積	333.0320895
							地積	333.03

## 画地面積(座標法)計算簿

画地番号：56- 3

点名	Xn	Yn	距離	方向角	X <sub>n+1</sub> -X <sub>n-1</sub>	Y <sub>n+1</sub> -Y <sub>n-1</sub>	X <sub>n</sub> *(Y <sub>n+1</sub> -Y <sub>n-1</sub> )	Y <sub>n</sub> *(X <sub>n+1</sub> -X <sub>n-1</sub> )
56- 5	47583.626	-70796.989	3.992	311° 52' 23"	10.096	-3.382	-160927.823132	-714766.400944
56- 6	47586.291	-70799.962	18.397	266° 50' 03"	1.649	-21.342	-1015586.622522	-116749.137338
56-30	47585.275	-70818.331	10.270	176° 45' 05"	-11.270	-17.787	-846399.286425	798122.590370
56-56	47575.021	-70817.749	21.201	86° 49' 33"	-9.080	21.751	1034804.281771	643025.160920
56-55	47576.195	-70796.580	7.442	356° 50' 59"	8.605	20.760	987681.808200	-609204.570900
							倍面積	-427.642108
							面積	213.8210540
							地積	213.82

## 画地面積(座標法)計算簿

画地番号：56- 4

点名	Xn	Yn	距離	方向角	X <sub>n+1</sub> -X <sub>n-1</sub>	Y <sub>n+1</sub> -Y <sub>n-1</sub>	X <sub>n</sub> *(Y <sub>n+1</sub> -Y <sub>n-1</sub> )	Y <sub>n</sub> *(X <sub>n+1</sub> -X <sub>n-1</sub> )
56-55	47576.195	-70796.580	21.201	266° 49' 33"	8.844	-21.721	-1033402.531595	-626124.953520
56-56	47575.021	-70817.749	16.235	176° 47' 13"	-17.384	-20.259	-963822.350439	1231095.748616
56-44	47558.811	-70816.839	5.099	176° 36' 19"	-21.301	1.212	57641.278932	1508469.487539
56-43	47553.720	-70816.537	22.699	86° 54' 32"	-3.867	22.968	1092213.840960	273847.548579
56-29	47554.944	-70793.871	0.703	342° 06' 23"	1.893	22.450	1067608.492800	-134012.797803
56-18	47555.613	-70794.087	2.689	344° 08' 22"	3.256	-0.951	-45225.387963	-230505.547272
56-19	47558.200	-70794.822	2.687	347° 54' 30"	5.215	-1.298	-61730.543600	-369194.996730
56-20	47560.828	-70795.385	2.684	351° 25' 56"	5.283	-0.963	-45801.077364	-374012.018955
56-21	47563.483	-70795.785	2.704	354° 50' 45"	5.349	-0.643	-30583.319569	-378686.653965
56-22	47566.177	-70796.028	10.033	356° 50' 46"	12.712	-0.795	-37815.110715	-899959.107936
<b>倍面積</b>								-916.708553
<b>面積</b>								458.3542765
<b>地積</b>								458.35

## 画地面積(座標法)計算簿

画地番号：56- 5

点名	X <sub>n</sub>	Y <sub>n</sub>	距離	方向角	X <sub>n+1</sub> -X <sub>n-1</sub>	Y <sub>n+1</sub> -Y <sub>n-1</sub>	X <sub>n</sub> *(Y <sub>n+1</sub> -Y <sub>n-1</sub> )	Y <sub>n</sub> *(X <sub>n+1</sub> -X <sub>n-1</sub> )
56-29	47554.944	-70793.871	22.699	266° 54' 32"	-0.642	-22.870	-1087581.569280	45449.665182
56-43	47553.720	-70816.537	13.412	176° 50' 45"	-14.616	-21.928	-1042757.972160	1035054.504792
56-92	47540.328	-70815.799	11.588	176° 52' 25"	-24.963	1.370	65130.249360	1767774.790437
56-57	47528.757	-70815.167	12.463	86° 52' 21"	-10.891	13.077	621533.555289	771247.983797
56-58	47529.437	-70802.722	8.684	144° 32' 51"	-6.394	17.482	830909.617634	452712.604468
56-110	47522.363	-70797.685	20.130	54° 32' 29"	4.604	21.434	1018594.328542	-325952.541740
56-109	47534.041	-70781.288	11.757	324° 32' 01"	21.254	9.575	455138.442575	-1504385.495152
56-12	47543.617	-70788.110	2.695	326° 41' 56"	11.829	-8.302	-394707.108334	-837352.553190
56-13	47545.870	-70789.590	2.691	330° 00' 53"	4.584	-2.825	-134317.082750	-324499.480560
56-14	47548.201	-70790.935	2.689	333° 21' 31"	4.735	-2.551	-121295.460751	-335195.077225
56-15	47550.605	-70792.141	2.692	337° 08' 22"	4.885	-2.252	-107083.962460	-345819.608785
56-16	47553.086	-70793.187	1.363	339° 23' 06"	3.757	-1.526	-72566.009236	-265970.003559
56-17	47554.362	-70793.667	0.616	340° 41' 01"	1.858	-0.684	-32527.183608	-131534.633286
							倍面積	-1530.155179
							面積	765.0775895
							地積	765.07

## 画地面積(座標法)計算簿

画地番号：56- 6

点名	Xn	Yn	距離	方向角	X <sub>n+1</sub> -X <sub>n-1</sub>	Y <sub>n+1</sub> -Y <sub>n-1</sub>	X <sub>n</sub> *(Y <sub>n+1</sub> -Y <sub>n-1</sub> )	Y <sub>n</sub> *(X <sub>n+1</sub> -X <sub>n-1</sub> )
56-59	47522.322	-70797.656	20.131	54° 32' 21"	11.638	16.426	780601.661172	-823943.120528
56-28	47534.001	-70781.259	0.049	324° 03' 28"	11.719	16.368	778036.528368	-829485.574221
56-109	47534.041	-70781.288	20.130	234° 32' 29"	-11.638	-16.426	-780794.157466	823752.629744
56-110	47522.363	-70797.685	0.050	144° 43' 39"	-11.719	-16.368	-777846.037584	829678.070515
							倍面積	-2.005510
							面積	1.0027550
							地積	1.00

## 画地面積(座標法)計算簿

画地番号：56- 7

点名	Xn	Yn	距離	方向角	X <sub>n+1</sub> -X <sub>n-1</sub>	Y <sub>n+1</sub> -Y <sub>n-1</sub>	X <sub>n</sub> *(Y <sub>n+1</sub> -Y <sub>n-1</sub> )	Y <sub>n</sub> *(X <sub>n+1</sub> -X <sub>n-1</sub> )
56-27	47515.754	-70768.258	22.404	324° 31' 48"	32.431	6.912	328428.891648	-2295085.375198
56-28	47534.001	-70781.259	20.131	234° 32' 21"	6.568	-29.398	-1397404.561398	-464891.309112
56-59	47522.322	-70797.656	4.317	234° 32' 22"	-14.184	-19.914	-946359.520308	1004193.952704
56-39	47519.817	-70801.173	13.477	144° 31' 41"	-13.481	4.304	204525.292368	954470.613213
56-107	47508.841	-70793.352	7.202	144° 31' 37"	-16.842	12.001	570153.600841	1192301.634384
56-105	47502.975	-70789.172	1.725	144° 31' 55"	-7.271	5.181	246112.913475	514708.069612
56-37	47501.570	-70788.171	24.448	54° 32' 16"	12.779	20.914	993447.834980	-904602.037209
							倍面積	-1095.548394
							面積	547.7741970
							地積	547.77



## 画地面積(座標法)計算簿

画地番号：56- 8

点名	X <sub>n</sub>	Y <sub>n</sub>	距離	方向角	X <sub>n+1</sub> -X <sub>n-1</sub>	Y <sub>n+1</sub> -Y <sub>n-1</sub>	X <sub>n</sub> *(Y <sub>n+1</sub> -Y <sub>n-1</sub> )	Y <sub>n</sub> *(X <sub>n+1</sub> -X <sub>n-1</sub> )
56-27	47515.754	-70768.258	24.448	234° 32' 16"	-2.834	-28.000	-1330441.112000	200557.243172
56-37	47501.570	-70788.171	22.024	234° 32' 15"	-26.962	-37.852	-1798029.427640	1908590.666502
56-35	47488.792	-70806.110	22.504	144° 31' 59"	-31.107	-4.881	-231792.793752	2202565.663770
56-36	47470.463	-70793.052	13.124	54° 35' 34"	-10.725	23.755	1127660.848565	759255.482700
56-52	47478.067	-70782.355	11.349	54° 32' 08"	14.189	19.941	946760.134047	-1004330.835095
56-62	47484.652	-70773.111	8.580	324° 31' 47"	13.573	4.265	202522.040780	-960603.435603
56-64	47491.640	-70778.090	22.000	54° 32' 14"	19.752	12.940	614541.821600	-1398008.833680
56-63	47504.404	-70760.171	13.936	324° 31' 47"	24.114	9.832	467063.300128	-1706310.763494
							倍面積	-1715.188272
							面積	857.5941360
							地積	857.59

## 画地面積(座標法)計算簿

画地番号：56- 9

点名	Xn	Yn	距離	方向角	X <sub>n+1</sub> -X <sub>n-1</sub>	Y <sub>n+1</sub> -Y <sub>n-1</sub>	X <sub>n</sub> *(Y <sub>n+1</sub> -Y <sub>n-1</sub> )	Y <sub>n</sub> *(X <sub>n+1</sub> -X <sub>n-1</sub> )
56-26	47497.416	-70755.192	8.580	324° 31' 47"	19.752	12.940	614616.563040	-1397556.552384
56-63	47504.404	-70760.171	22.000	234° 32' 14"	-5.776	-22.898	-1087755.842792	408710.747696
56-64	47491.640	-70778.090	8.580	144° 31' 47"	-19.752	-12.940	-614541.821600	1398008.833680
56-62	47484.652	-70773.111	22.000	54° 32' 14"	5.776	22.898	1087303.561496	-408785.489136
<b>倍面積</b>								-377.539856
<b>面積</b>								188.7699280
<b>地積</b>								188.76

## 画地面積(座標法)計算簿

画地番号：56-10

点名	Xn	Yn	距離	方向角	X <sub>n+1</sub> -X <sub>n-1</sub>	Y <sub>n+1</sub> -Y <sub>n-1</sub>	X <sub>n</sub> *(Y <sub>n+1</sub> -Y <sub>n-1</sub> )	Y <sub>n</sub> *(X <sub>n+1</sub> -X <sub>n-1</sub> )
56-26	47497.416	-70755.192	22.000	234° 32' 14"	3.578	-29.576	-1404783.575616	-253162.076976
56-62	47484.652	-70773.111	11.349	234° 32' 08"	-19.349	-27.163	-1289825.602276	1369388.924739
56-52	47478.067	-70782.355	20.062	144° 30' 45"	-22.921	2.403	114089.795001	1622402.358955
56-54	47461.731	-70770.708	33.354	54° 33' 18"	3.007	38.820	1842464.397420	-212807.518956
56-53	47481.074	-70743.535	20.073	324° 29' 57"	35.685	15.516	736716.344184	-2524483.046475
							倍面積	-1338.641287
							面積	669.3206435
							地積	669.32

## 画地面積(座標法)計算簿

画地番号：56-11

点名	Xn	Yn	距離	方向角	X <sub>n+1</sub> -X <sub>n-1</sub>	Y <sub>n+1</sub> -Y <sub>n-1</sub>	X <sub>n</sub> *(Y <sub>n+1</sub> -Y <sub>n-1</sub> )	Y <sub>n</sub> *(X <sub>n+1</sub> -X <sub>n-1</sub> )
56-51	47450.087	-70762.405	30.522	54° 33' 17"	6.057	33.169	1573871.935703	-428607.887085
56- 3	47467.788	-70737.539	4.008	9° 33' 48"	21.654	25.532	1211947.563216	-1531750.669506
56- 4	47471.741	-70736.873	11.466	324° 28' 49"	13.286	-5.996	-284640.559036	-939810.094678
56-53	47481.074	-70743.535	33.354	234° 33' 18"	-10.010	-33.835	-1606522.138790	708142.785350
56-54	47461.731	-70770.708	14.301	144° 30' 30"	-30.987	-18.870	-895602.863970	2192971.928796
							倍面積	-946.062877
							面積	473.0314385
							地積	473.03

## 画地面積(座標法)計算簿

画地番号：56-12

点名	X <sub>n</sub>	Y <sub>n</sub>	距離	方向角	X <sub>n+1</sub> -X <sub>n-1</sub>	Y <sub>n+1</sub> -Y <sub>n-1</sub>	X <sub>n</sub> *(Y <sub>n+1</sub> -Y <sub>n-1</sub> )	Y <sub>n</sub> *(X <sub>n+1</sub> -X <sub>n-1</sub> )
56-52	47478.067	-70782.355	13.124	234° 35' 34"	8.732	-22.344	-1060849.929048	-618071.523860
56-36	47470.463	-70793.052	31.531	144° 33' 23"	-33.292	7.588	360205.873244	2356842.287184
56- 1	47444.775	-70774.767	4.016	99° 21' 24"	-26.341	22.248	1055551.354200	1864278.137547
56- 2	47444.122	-70770.804	10.301	54° 37' 03"	5.312	12.362	586504.236164	-375934.510848
56-51	47450.087	-70762.405	14.301	324° 30' 30"	17.609	0.096	4555.208352	-1246055.189645
56-54	47461.731	-70770.708	20.062	324° 30' 45"	27.980	-19.950	-946861.533450	-1980164.409840
							倍面積	-894.790538
							面積	447.3952690
							地積	447.39

## 画地面積(座標法)計算簿

画地番号：56-13

点名	X <sub>n</sub>	Y <sub>n</sub>	距離	方向角	X <sub>n+1</sub> -X <sub>n-1</sub>	Y <sub>n+1</sub> -Y <sub>n-1</sub>	X <sub>n</sub> *(Y <sub>n+1</sub> -Y <sub>n-1</sub> )	Y <sub>n</sub> *(X <sub>n+1</sub> -X <sub>n-1</sub> )
56-35	47488.792	-70806.110	22.024	54° 32' 15"	11.372	18.940	899437.720480	-805207.082920
56-37	47501.570	-70788.171	1.725	324° 31' 55"	14.183	16.938	804581.592660	-1003988.629293
56-105	47502.975	-70789.172	22.024	234° 32' 23"	-11.372	-18.940	-899706.346500	805014.463984
56-106	47490.198	-70807.111	1.725	144° 33' 04"	-14.183	-16.938	-804388.973724	1004257.255313
							倍面積	-76.007084
							面積	38.0035420
							地積	38.00

## 画地面積(座標法)計算簿

画地番号：56-14

点名	Xn	Yn	距離	方向角	X <sub>n+1</sub> -X <sub>n-1</sub>	Y <sub>n+1</sub> -Y <sub>n-1</sub>	X <sub>n</sub> *(Y <sub>n+1</sub> -Y <sub>n-1</sub> )	Y <sub>n</sub> *(X <sub>n+1</sub> -X <sub>n-1</sub> )
56-106	47490.198	-70807.111	22.024	54° 32' 23"	6.909	22.116	1050293.218968	-489206.329899
56-105	47502.975	-70789.172	7.202	324° 31' 37"	18.643	13.759	653593.433025	-1319722.533596
56-107	47508.841	-70793.352	22.020	234° 32' 22"	-6.909	-22.116	-1050705.527556	489111.268968
56-108	47496.066	-70811.288	7.202	144° 33' 21"	-18.643	-13.759	-653498.372094	1320134.842184
							倍面積	-317.247657
							面積	158.6238285
							地積	158.62

## 画地面積(座標法)計算簿

画地番号：56-15

点名	Xn	Yn	距離	方向角	X <sub>n+1</sub> -X <sub>n-1</sub>	Y <sub>n+1</sub> -Y <sub>n-1</sub>	X <sub>n</sub> *(Y <sub>n+1</sub> -Y <sub>n-1</sub> )	Y <sub>n</sub> *(X <sub>n+1</sub> -X <sub>n-1</sub> )
56-108	47496.066	-70811.288	22.020	54° 32' 22"	-4.827	30.463	1446872.658558	341806.087176
56-107	47508.841	-70793.352	13.477	324° 31' 41"	23.751	10.115	480551.926715	-1681412.903352
56-39	47519.817	-70801.173	4.317	54° 32' 22"	13.481	-4.304	-204525.292368	-954470.613213
56-59	47522.322	-70797.656	0.050	324° 43' 39"	2.546	3.488	165757.859136	-180250.832176
56-110	47522.363	-70797.685	8.684	324° 32' 51"	7.115	-5.066	-240748.290958	-503725.528775
56-58	47529.437	-70802.722	12.463	266° 52' 21"	6.394	-17.482	-830909.617634	-452712.604468
56-57	47528.757	-70815.167	4.716	176° 52' 34"	-5.389	-12.188	-579280.490316	381622.934963
56-40	47524.048	-70814.910	14.377	234° 28' 29"	-13.063	-11.444	-543865.205312	925055.169330
56-33	47515.694	-70826.611	3.452	125° 55' 38"	-10.380	-8.905	-423127.255070	735180.222180
56-25	47513.668	-70823.815	21.604	144° 33' 41"	-19.628	15.323	728051.934764	1390129.840820
<b>倍面積</b>								-1221.772485
<b>面積</b>								610.8862425
<b>地積</b>								610.88



## 画地面積(座標法)計算簿

画地番号：56-16

点名	Xn	Yn	距離	方向角	X <sub>n+1</sub> -X <sub>n-1</sub>	Y <sub>n+1</sub> -Y <sub>n-1</sub>	X <sub>n</sub> *(Y <sub>n+1</sub> -Y <sub>n-1</sub> )	Y <sub>n</sub> *(X <sub>n+1</sub> -X <sub>n-1</sub> )
56-40	47524.048	-70814.910	4.716	356° 52' 34"	13.063	11.444	543865.205312	-925055.169330
56-57	47528.757	-70815.167	11.588	356° 52' 25"	16.280	-0.889	-42253.064973	-1152870.918760
56-92	47540.328	-70815.799	2.261	266° 49' 53"	11.446	-2.890	-137391.547920	-810557.635354
56-104	47540.203	-70818.057	12.184	266° 50' 18"	-0.797	-14.424	-685719.888072	56441.991429
56-91	47539.531	-70830.223	2.286	176° 50' 28"	-2.955	-12.040	-572375.953240	209303.308965
56-94	47537.248	-70830.097	18.419	176° 50' 17"	-20.674	1.142	54287.537216	1464341.425378
56-96	47518.857	-70829.081	2.501	234° 29' 11"	-19.844	-1.020	-48469.234140	1405532.283364
56-95	47517.404	-70831.117	4.292	108° 46' 06"	-2.834	2.028	96365.295312	200735.385578
56-24	47516.023	-70827.053	0.551	126° 39' 43"	-1.710	4.506	214107.199638	121114.260630
56-33	47515.694	-70826.611	14.377	54° 28' 29"	8.025	12.143	576983.072242	-568383.553275
<b>倍面積</b>								-601.378625
<b>面積</b>								300.6893125
<b>地積</b>								300.68

## 画地面積(座標法)計算簿

画地番号：56-17

点名	X <sub>n</sub>	Y <sub>n</sub>	距離	方向角	X <sub>n+1</sub> -X <sub>n-1</sub>	Y <sub>n+1</sub> -Y <sub>n-1</sub>	X <sub>n</sub> *(Y <sub>n+1</sub> -Y <sub>n-1</sub> )	Y <sub>n</sub> *(X <sub>n+1</sub> -X <sub>n-1</sub> )
56-94	47537.248	-70830.097	14.682	266° 50' 29"	17.582	-15.676	-745193.899648	-1245334.765454
56-93	47536.439	-70844.757	12.298	176° 49' 50"	-13.089	-13.980	-664559.417220	927287.024373
56-9	47524.159	-70844.077	4.012	142° 23' 26"	-15.459	3.129	148703.093511	1095178.586343
56-10	47520.980	-70841.628	11.102	108° 47' 21"	-6.755	12.960	615871.900800	478535.197140
56-95	47517.404	-70831.117	2.501	54° 29' 11"	-2.123	12.547	596200.867988	150374.461391
56-96	47518.857	-70829.081	18.419	356° 50' 17"	19.844	1.020	48469.234140	-1405532.283364
							倍面積	-508.220429
							面積	254.1102145
							地積	254.11

## 画地面積(座標法)計算簿

画地番号：56-18

点名	Xn	Yn	距離	方向角	X <sub>n+1</sub> -X <sub>n-1</sub>	Y <sub>n+1</sub> -Y <sub>n-1</sub>	X <sub>n</sub> *(Y <sub>n+1</sub> -Y <sub>n-1</sub> )	Y <sub>n</sub> *(X <sub>n+1</sub> -X <sub>n-1</sub> )
56-91	47539.531	-70830.223	12.675	266° 50' 19"	1.584	-12.782	-607650.285242	-112195.073232
56-90	47538.832	-70842.879	2.510	229° 54' 40"	-2.316	-14.577	-692973.554064	164072.107764
56-89	47537.215	-70844.800	0.777	176° 49' 42"	-2.393	-1.878	-89274.889770	169531.606400
56-93	47536.439	-70844.757	14.682	86° 50' 29"	0.033	14.703	698928.262617	-2337.876981
56-94	47537.248	-70830.097	2.286	356° 50' 28"	3.092	14.534	690906.362432	-219006.659924
							倍面積	-64.104027
							面積	32.0520135
							地積	32.05

## 画地面積(座標法)計算簿

画地番号：56-19

点名	X <sub>n</sub>	Y <sub>n</sub>	距離	方向角	X <sub>n+1</sub> -X <sub>n-1</sub>	Y <sub>n+1</sub> -Y <sub>n-1</sub>	X <sub>n</sub> *(Y <sub>n+1</sub> -Y <sub>n-1</sub> )	Y <sub>n</sub> *(X <sub>n+1</sub> -X <sub>n-1</sub> )
56-89	47537.215	-70844.800	2.510	49° 54' 40"	-3.375	2.204	104772.021860	239101.200000
56-90	47538.832	-70842.879	12.675	86° 50' 19"	2.316	14.577	692973.554064	-164072.107764
56-91	47539.531	-70830.223	12.184	86° 50' 18"	1.371	24.822	1180026.238482	-97108.235733
56-104	47540.203	-70818.057	18.510	356° 46' 45"	19.153	11.126	528932.298578	-1356378.245721
56-103	47558.684	-70819.097	10.302	266° 47' 02"	17.903	-11.326	-538649.654984	-1267874.293591
56-102	47558.106	-70829.383	0.695	266° 47' 01"	-0.617	-10.980	-522188.003880	43701.729311
56-88	47558.067	-70830.077	15.000	176° 43' 43"	-15.015	0.162	7704.406854	1063513.606155
56-87	47543.091	-70829.221	15.886	266° 48' 37"	-15.860	-15.006	-713431.623546	1123351.445060
56-86	47542.207	-70845.083	5.000	176° 45' 19"	-5.876	-15.579	-740660.042853	416285.707708
							倍面積	-520.805425
							面積	260.4027125
							地積	260.40

## 画地面積(座標法)計算簿

画地番号：56-20

点名	Xn	Yn	距離	方向角	X <sub>n+1</sub> -X <sub>n-1</sub>	Y <sub>n+1</sub> -Y <sub>n-1</sub>	X <sub>n</sub> *(Y <sub>n+1</sub> -Y <sub>n-1</sub> )	Y <sub>n</sub> *(X <sub>n+1</sub> -X <sub>n-1</sub> )
56-43	47553.720	-70816.537	5.099	356° 36' 19"	18.483	-1.040	-49455.868800	-1308902.053371
56-44	47558.811	-70816.839	2.261	266° 46' 51"	4.964	-2.560	-121750.556160	-351534.788796
56-103	47558.684	-70819.097	18.510	176° 46' 45"	-18.608	-1.218	-57926.477112	1317801.756976
56-104	47540.203	-70818.057	2.261	86° 49' 53"	-18.356	3.298	156787.589494	1299936.254292
56-92	47540.328	-70815.799	13.412	356° 50' 45"	13.517	1.520	72261.298560	-957217.155083
							倍面積	-84.014018
							面積	42.0070090
							地積	42.00

## 画地面積(座標法)計算簿

画地番号：56-21

点名	Xn	Yn	距離	方向角	X <sub>n+1</sub> -X <sub>n-1</sub>	Y <sub>n+1</sub> -Y <sub>n-1</sub>	X <sub>n</sub> *(Y <sub>n+1</sub> -Y <sub>n-1</sub> )	Y <sub>n</sub> *(X <sub>n+1</sub> -X <sub>n-1</sub> )
56-86	47542.207	-70845.083	15.886	86° 48' 37"	-14.103	16.696	793764.688072	999128.205549
56-87	47543.091	-70829.221	15.000	356° 43' 43"	15.860	15.006	713431.623546	-1123351.445060
56-88	47558.067	-70830.077	15.864	266° 50' 43"	14.103	-16.696	-794029.486632	-998916.575931
56-31	47557.194	-70845.917	15.010	176° 48' 54"	-15.860	-15.006	-713643.253164	1123616.243620
							倍面積	-476.428178
							面積	238.2140890
							地積	238.21

## 画地面積(座標法)計算簿

画地番号：56-22

点名	Xn	Yn	距離	方向角	X <sub>n+1</sub> -X <sub>n-1</sub>	Y <sub>n+1</sub> -Y <sub>n-1</sub>	X <sub>n</sub> *(Y <sub>n+1</sub> -Y <sub>n-1</sub> )	Y <sub>n</sub> *(X <sub>n+1</sub> -X <sub>n-1</sub> )
56-100	47571.177	-70830.116	16.551	266° 58' 48"	12.199	-17.262	-821173.657374	-864056.585084
56-101	47570.305	-70846.645	13.131	176° 49' 19"	-13.983	-15.801	-751658.389305	990648.637035
56-31	47557.194	-70845.917	15.864	86° 50' 43"	-12.238	16.568	787927.590192	867012.332246
56-88	47558.067	-70830.077	0.695	86° 47' 01"	0.912	16.534	786325.079778	-64597.030224
56-102	47558.106	-70829.383	13.091	356° 47' 25"	13.110	-0.039	-1854.766134	-928573.211130
							倍面積	-434.142843
							面積	217.0714215
							地積	217.07