

# 62街区 画地出来形確認図 (4310.64m<sup>2</sup>)

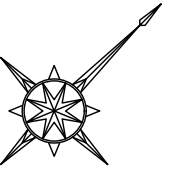

S=1:500

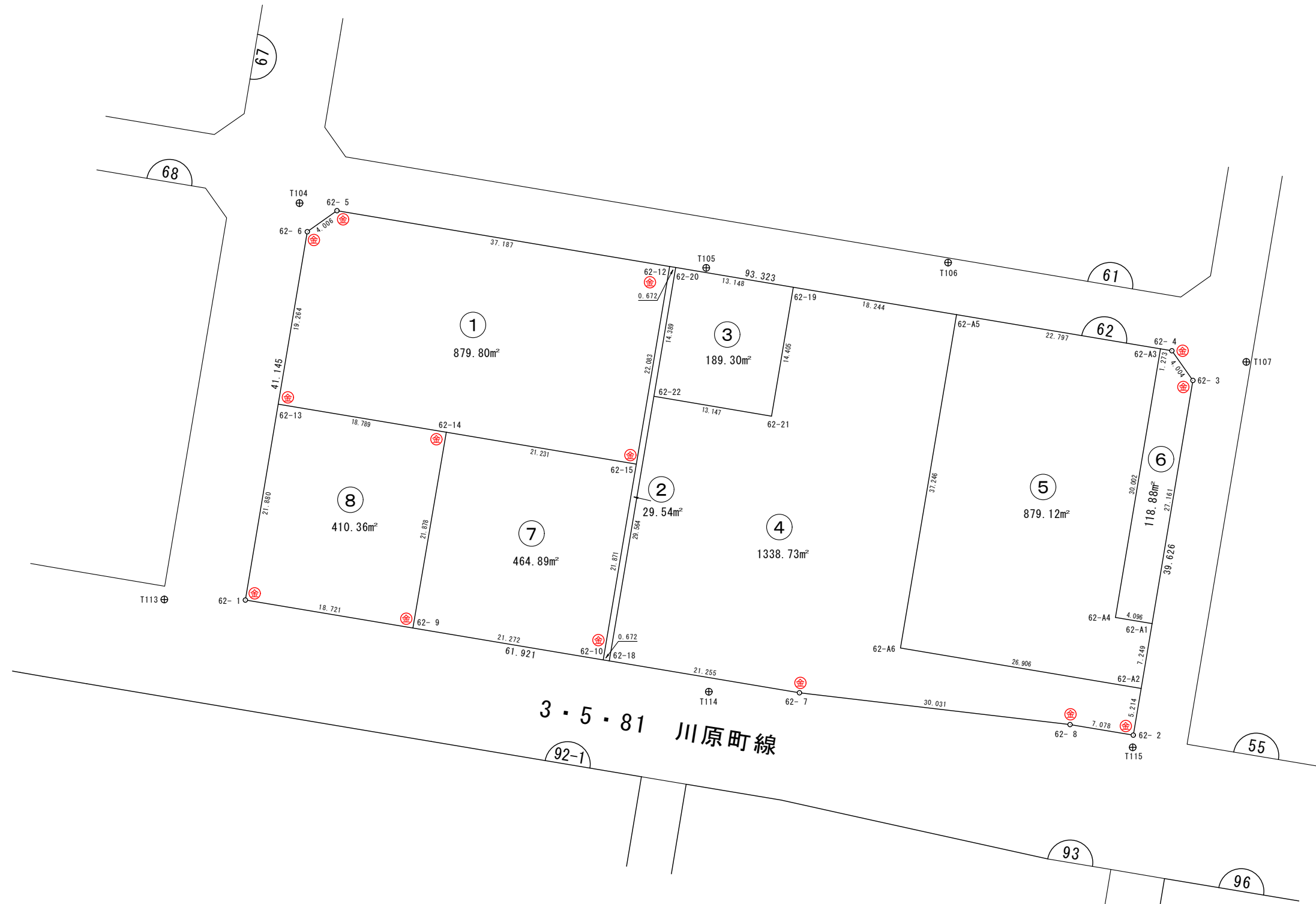

凡 例	
事 項	記 号
金属プレート	⊕
コンクリート杭	⊖
金属釘	⊗
合成樹脂杭	⊙
マーキング	⊚

## 画地面積(座標法)計算簿

画地番号：62- 1

点名	Xn	Yn	距離	方向角	X <sub>n+1</sub> -X <sub>n-1</sub>	Y <sub>n+1</sub> -Y <sub>n-1</sub>	X <sub>n</sub> *(Y <sub>n+1</sub> -Y <sub>n-1</sub> )	Y <sub>n</sub> *(X <sub>n+1</sub> -X <sub>n-1</sub> )
62- 5	47284.133	-70721.245	4.006	189° 39' 18"	-25.537	-30.953	-1463585.768749	1806008.433565
62- 6	47280.183	-70721.917	19.264	144° 34' 39"	-19.649	10.494	496158.240402	1389614.947133
62-13	47264.484	-70710.751	18.789	54° 28' 28"	-4.781	26.458	1250523.717672	338068.100531
62-14	47275.402	-70695.459	21.231	54° 31' 53"	23.238	32.584	1540421.698768	-1642821.076242
62-15	47287.722	-70678.167	22.083	324° 35' 11"	30.318	4.495	212558.310390	-2142820.667106
62-12	47305.720	-70690.964	37.187	234° 30' 55"	-3.589	-43.078	-2037835.806160	253709.869796
							倍面積	-1759.607677
							面積	879.8038385
							地積	879.80

## 画地面積(座標法)計算簿

画地番号：62- 2

点名	Xn	Yn	距離	方向角	X <sub>n+1</sub> -X <sub>n-1</sub>	Y <sub>n+1</sub> -Y <sub>n-1</sub>	X <sub>n</sub> *(Y <sub>n+1</sub> -Y <sub>n-1</sub> )	Y <sub>n</sub> *(X <sub>n+1</sub> -X <sub>n-1</sub> )
62-10	47269.896	-70665.495	0.672	54° 33' 41"	-17.436	13.220	624908.025120	1232123.570820
62-18	47270.286	-70664.947	29.564	324° 35' 21"	24.486	-16.583	-783883.152738	-1730301.892242
62-22	47294.382	-70682.078	14.389	324° 35' 21"	35.824	-25.469	-1204540.615158	-2532114.762272
62-20	47306.110	-70690.416	0.672	234° 33' 41"	11.338	-8.886	-420362.093460	-801487.936608
62-12	47305.720	-70690.964	22.083	144° 35' 11"	-18.388	12.249	579447.764280	1299865.446032
62-15	47287.722	-70678.167	21.871	144° 35' 31"	-35.824	25.469	1204370.991618	2531974.654608
							倍面積	-59.080338
							面積	29.5401690
							地積	29.54

## 画地面積(座標法)計算簿

画地番号：62- 3

点名	Xn	Yn	距離	方向角	X <sub>n+1</sub> -X <sub>n-1</sub>	Y <sub>n+1</sub> -Y <sub>n-1</sub>	X <sub>n</sub> *(Y <sub>n+1</sub> -Y <sub>n-1</sub> )	Y <sub>n</sub> *(X <sub>n+1</sub> -X <sub>n-1</sub> )
62-20	47306.110	-70690.416	14.389	144° 35' 21"	-19.359	-2.369	-112068.174590	1368495.763344
62-22	47294.382	-70682.078	13.147	54° 35' 28"	-4.110	19.054	901147.154628	290503.340580
62-21	47302.000	-70671.362	14.405	324° 35' 24"	19.359	2.369	112058.438000	-1368126.896958
62-19	47313.741	-70679.709	13.148	234° 31' 20"	4.110	-19.054	-901516.021014	-290493.603990
							倍面積	-378.602976
							面積	189.3014880
							地積	189.30

## 画地面積(座標法)計算簿

画地番号：62- 4

点名	Xn	Yn	距離	方向角	X <sub>n+1</sub> -X <sub>n-1</sub>	Y <sub>n+1</sub> -Y <sub>n-1</sub>	X <sub>n</sub> *(Y <sub>n+1</sub> -Y <sub>n-1</sub> )	Y <sub>n</sub> *(X <sub>n+1</sub> -X <sub>n-1</sub> )
62-19	47313.741	-70679.709	14.405	144° 35' 24"	-22.331	-6.510	-308012.453910	1578348.581679
62-21	47302.000	-70671.362	13.147	234° 35' 28"	-19.359	-2.369	-112058.438000	1368126.896958
62-22	47294.382	-70682.078	29.564	144° 35' 21"	-31.714	6.415	303393.460530	2241611.421692
62-18	47270.286	-70664.947	21.255	54° 30' 47"	-11.757	34.438	1627894.109268	830807.781879
62- 7	47282.625	-70647.640	30.031	51° 41' 40"	30.954	40.873	1932582.731625	-2186827.048560
62- 8	47301.240	-70624.074	7.078	54° 29' 12"	22.727	29.328	1387250.766720	-1605073.329798
62- 2	47305.352	-70618.312	5.214	324° 31' 48"	8.359	2.736	129427.443072	-590298.470008
62-A2	47309.599	-70621.338	26.906	234° 31' 59"	-11.365	-24.940	-1179901.399060	802611.506370
62-A6	47293.987	-70643.252	37.246	324° 33' 19"	14.732	-43.514	-2057950.550318	-1040716.388464
62-A5	47324.331	-70664.852	18.244	234° 31' 08"	19.754	-36.457	-1725303.135267	-1395913.486408
							倍面積	-2677.465340
							面積	1338.7326700
							地積	1338.73

## 画地面積(座標法)計算簿

画地番号：62- 5

点名	Xn	Yn	距離	方向角	X <sub>n+1</sub> -X <sub>n-1</sub>	Y <sub>n+1</sub> -Y <sub>n-1</sub>	X <sub>n</sub> *(Y <sub>n+1</sub> -Y <sub>n-1</sub> )	Y <sub>n</sub> *(X <sub>n+1</sub> -X <sub>n-1</sub> )
62-A5	47324.331	-70664.852	37.246	144° 33' 19"	-43.576	3.036	143676.668916	3079291.590752
62-A6	47293.987	-70643.252	26.906	54° 31' 59"	-14.732	43.514	2057950.550318	1040716.388464
62-A2	47309.599	-70621.338	7.249	324° 32' 19"	21.517	17.708	837758.379092	-1519559.329746
62-A1	47315.504	-70625.544	4.096	234° 31' 44"	3.528	-7.542	-356853.531168	-249166.919232
62-A4	47313.127	-70628.880	30.002	324° 32' 03"	22.059	-20.744	-981463.506488	-1558002.463920
62-A3	47337.563	-70646.288	22.797	234° 31' 11"	11.204	-35.972	-1702826.816236	-791521.010752
							倍面積	-1758.255566
							面積	879.1277830
							地積	879.12

## 画地面積(座標法)計算簿

画地番号：62- 6

点名	Xn	Yn	距離	方向角	X <sub>n+1</sub> -X <sub>n-1</sub>	Y <sub>n+1</sub> -Y <sub>n-1</sub>	X <sub>n</sub> *(Y <sub>n+1</sub> -Y <sub>n-1</sub> )	Y <sub>n</sub> *(X <sub>n+1</sub> -X <sub>n-1</sub> )
62-A3	47337.563	-70646.288	30.002	144° 32' 03"	-25.175	16.371	774963.243873	1778520.300400
62-A4	47313.127	-70628.880	4.096	54° 31' 44"	-22.059	20.744	981463.506488	1558002.463920
62-A1	47315.504	-70625.544	27.161	324° 32' 00"	24.499	-12.424	-587847.821696	-1730255.202456
62- 3	47337.626	-70641.304	4.004	279° 43' 07"	22.798	-19.707	-932882.595582	-1610480.448592
62- 4	47338.302	-70645.251	1.273	234° 31' 30"	-0.063	-4.984	-235934.097168	4450.650813
							倍面積	-237.764085
							面積	118.8820425
							地積	118.88

## 画地面積(座標法)計算簿

画地番号：62- 7

点名	Xn	Yn	距離	方向角	X <sub>n+1</sub> -X <sub>n-1</sub>	Y <sub>n+1</sub> -Y <sub>n-1</sub>	X <sub>n</sub> *(Y <sub>n+1</sub> -Y <sub>n-1</sub> )	Y <sub>n</sub> *(X <sub>n+1</sub> -X <sub>n-1</sub> )
62-14	47275.402	-70695.459	21.878	144° 41' 58"	-30.176	-4.649	-219783.343898	2133306.170784
62- 9	47257.546	-70682.816	21.272	54° 30' 39"	-5.506	29.964	1416025.108344	389179.584896
62-10	47269.896	-70665.495	21.871	324° 35' 31"	30.176	4.649	219757.746504	-2132401.977120
62-15	47287.722	-70678.167	21.231	234° 31' 53"	5.506	-29.964	-1416929.302008	-389153.987502
							倍面積	-929.791058
							面積	464.8955290
							地積	464.89



## 画地面積(座標法)計算簿

画地番号：62- 8

点名	Xn	Yn	距離	方向角	X <sub>n+1</sub> -X <sub>n-1</sub>	Y <sub>n+1</sub> -Y <sub>n-1</sub>	X <sub>n</sub> *(Y <sub>n+1</sub> -Y <sub>n-1</sub> )	Y <sub>n</sub> *(X <sub>n+1</sub> -X <sub>n-1</sub> )
62- 9	47257.546	-70682.816	21.878	324° 41' 58"	28.736	2.592	122491.559232	-2031141.400576
62-14	47275.402	-70695.459	18.789	234° 28' 28"	6.938	-27.935	-1320638.354870	-490485.094542
62-13	47264.484	-70710.751	21.880	144° 31' 13"	-28.736	-2.592	-122509.542528	2031944.140736
62- 1	47246.666	-70698.051	18.721	54° 28' 04"	-6.938	27.935	1319835.614710	490503.077838
<b>倍面積</b>								-820.723456
<b>面積</b>								410.3617280
<b>地積</b>								410.36