

# 63-1, 63-2街区 画地出来形確認図 (4130.93m<sup>2</sup>)

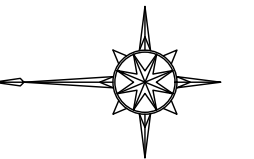

S=1:500

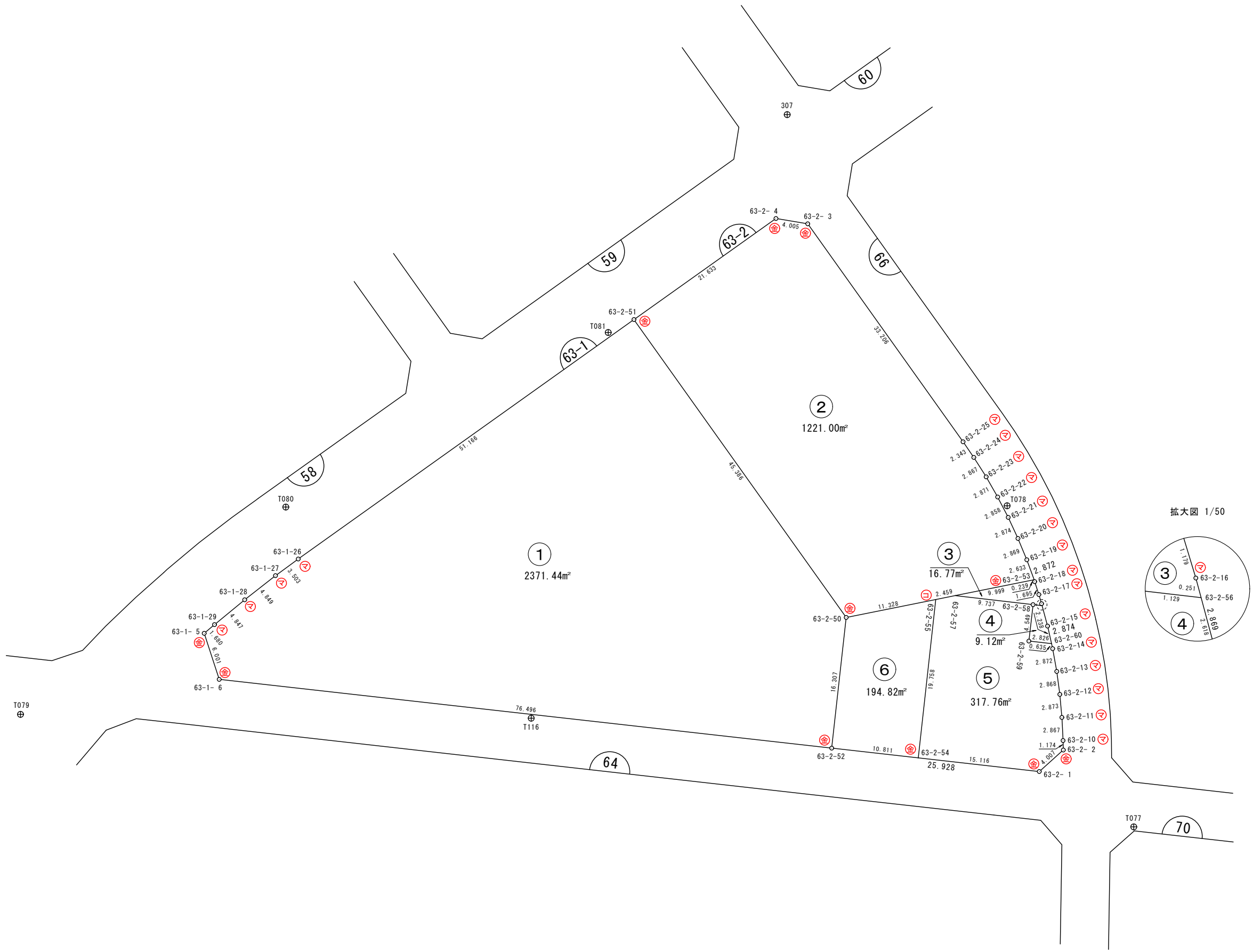

拡大図 1/50

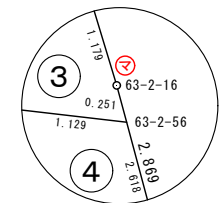

凡 例	
事 項	記 号
金属プレート	⊕
コンクリート杭	⊙
金属板	⊗
合成樹脂杭	⊕
マーキング	⊖

# 公共設施用地面積計算簿

63-1街区

点名	X <sub>n</sub>	Y <sub>n</sub>	距離	方向角	X <sub>n+1</sub> -X <sub>n-1</sub>	Y <sub>n+1</sub> -Y <sub>n-1</sub>	Y <sub>n</sub> *(X <sub>n+1</sub> -X <sub>n-1</sub> )	X <sub>n</sub> *(Y <sub>n+1</sub> -Y <sub>n-1</sub> )	
63-2-50	47359.630	-70845.323	45.386	54° 30' 46"	24.545	53.164	-1738898.453035	2517827.369320	
63-2-51	47385.978	-70808.367	51.166	324° 30' 41"	68.009	7.252	-4815606.231303	343643.112456	
63-1-26	47427.639	-70838.071	3.503	323° 49' 25"	44.489	-31.772	-3151514.940719	-1506870.946308	
63-1-27	47430.467	-70840.139	4.849	321° 58' 37"	6.648	-5.055	-470945.244072	-239761.010685	
63-1-28	47434.287	-70843.126	4.847	320° 33' 00"	7.563	-6.067	-535786.561938	-287783.819229	
63-1-29	47438.030	-70846.206	1.680	319° 41' 01"	5.024	-4.167	-355931.338944	-197674.271010	
63-1-5	47439.311	-70847.293	6.001	251° 57' 16"	-0.578	-6.793	40949.735354	-322255.239623	
63-1-6	47437.452	-70852.999	76.496	186° 24' 14"	-77.878	-14.238	5517889.856122	-675414.441576	
63-2-52	47361.433	-70861.531	16.307	96° 20' 51"	-77.822	7.676	5514586.065482	363546.359708	
							倍面積	4742.886947	-4742.886947
							面積		2371.4434735
							地積		2371.44

## 画地面積(座標法)計算簿

画地番号：63- 2-2

点名	Xn	Yn	距離	方向角	X <sub>n+1</sub> -X <sub>n-1</sub>	Y <sub>n+1</sub> -Y <sub>n-1</sub>	X <sub>n</sub> *(Y <sub>n+1</sub> -Y <sub>n-1</sub> )	Y <sub>n</sub> *(X <sub>n+1</sub> -X <sub>n-1</sub> )
63-2-51	47385.978	-70808.367	45.386	234° 30' 46"	-8.720	-49.497	-2345463.753066	617448.960240
63-2-50	47359.630	-70845.323	11.328	168° 40' 59"	-37.456	-34.733	-1644942.028790	2653582.418288
63-2-55	47348.522	-70843.100	2.459	168° 37' 34"	-13.519	2.708	128219.797576	957727.868900
63-2-57	47346.111	-70842.615	9.999	168° 37' 13"	-12.214	2.458	116376.740838	865271.699610
63-2-53	47336.308	-70840.642	2.633	69° 53' 59"	-8.898	4.446	210457.225368	630340.032516
63-2-19	47337.213	-70838.169	2.869	67° 30' 05"	2.003	5.124	242555.879412	-141888.852507
63-2-20	47338.311	-70835.518	2.874	65° 10' 24"	2.305	5.260	248999.515860	-163275.868990
63-2-21	47339.518	-70832.909	2.858	62° 29' 37"	2.527	5.144	243514.480592	-178994.761043
63-2-22	47340.838	-70830.374	2.871	60° 19' 10"	2.742	5.030	238124.415140	-194216.885508
63-2-23	47342.260	-70827.879	2.867	57° 31' 05"	2.962	4.914	232639.865640	-209792.177598
63-2-24	47343.800	-70825.460	2.343	55° 32' 13"	2.866	4.351	205992.873800	-202985.768360
63-2-25	47345.126	-70823.528	33.206	54° 31' 08"	20.600	28.972	1371682.990472	-1458964.676800
63-2- 3	47364.400	-70796.488	4.005	9° 30' 51"	23.224	27.702	1312088.608800	-1644177.637312
63-2- 4	47368.350	-70795.826	21.633	324° 34' 16"	21.578	-11.879	-562688.629650	-1527632.333428
							倍面積	-2442.018008
							面積	1221.0090040
							地積	1221.00

## 画地面積(座標法)計算簿

画地番号：63- 2-3

点名	Xn	Yn	距離	方向角	X <sub>n+1</sub> -X <sub>n-1</sub>	Y <sub>n+1</sub> -Y <sub>n-1</sub>	X <sub>n</sub> *(Y <sub>n+1</sub> -Y <sub>n-1</sub> )	Y <sub>n</sub> *(X <sub>n+1</sub> -X <sub>n-1</sub> )
63-2-53	47336.308	-70840.642	9.999	348° 37' 13"	9.872	-1.744	-82554.521152	-699338.817824
63-2-57	47346.111	-70842.615	9.737	186° 34' 08"	0.129	-3.087	-146157.444657	-9138.697335
63-2-58	47336.437	-70843.729	1.129	186° 33' 31"	-10.796	-1.243	-58839.191191	764828.898284
63-2-56	47335.315	-70843.858	0.251	75° 01' 28"	-1.057	0.114	5396.225910	74881.957906
63-2-16	47335.380	-70843.615	1.179	73° 08' 50"	0.407	1.372	64944.141360	-28833.351305
63-2-17	47335.722	-70842.486	1.695	72° 14' 56"	0.859	2.744	129889.221168	-60853.695474
63-2-18	47336.239	-70840.871	0.239	73° 13' 55"	0.586	1.844	87288.024716	-41512.750406
							倍面積	-33.543846
							面積	16.7719230
							地積	16.77

## 画地面積(座標法)計算簿

画地番号：63- 2-4

点名	Xn	Yn	距離	方向角	X <sub>n+1</sub> -X <sub>n-1</sub>	Y <sub>n+1</sub> -Y <sub>n-1</sub>	X <sub>n</sub> *(Y <sub>n+1</sub> -Y <sub>n-1</sub> )	Y <sub>n</sub> *(X <sub>n+1</sub> -X <sub>n-1</sub> )
63-2-56	47335.315	-70843.858	1.129	6° 33' 31"	1.800	2.658	125817.267270	-127518.944400
63-2-58	47336.437	-70843.729	4.549	276° 33' 46"	1.642	-4.391	-207854.294867	-116325.403018
63-2-59	47336.957	-70848.249	2.826	186° 33' 43"	-2.288	-4.843	-229252.882751	162100.793712
63-2-60	47334.149	-70848.572	2.238	77° 24' 36"	-2.320	1.862	88136.185438	164368.687040
63-2-15	47334.637	-70846.387	2.618	74° 59' 33"	1.166	4.714	223135.478818	-82606.887242
							倍面積	-18.246092
							面積	9.1230460
							地積	9.12

## 画地面積(座標法)計算簿

画地番号：63- 2-5

点名	Xn	Yn	距離	方向角	X <sub>n+1</sub> -X <sub>n-1</sub>	Y <sub>n+1</sub> -Y <sub>n-1</sub>	X <sub>n</sub> *(Y <sub>n+1</sub> -Y <sub>n-1</sub> )	Y <sub>n</sub> *(X <sub>n+1</sub> -X <sub>n-1</sub> )
63-2-57	47346.111	-70842.615	2.459	348° 37' 34"	12.085	0.629	29780.703819	-856133.002275
63-2-55	47348.522	-70843.100	19.758	276° 17' 48"	4.578	-20.124	-952841.656728	-324319.711800
63-2-54	47350.689	-70862.739	15.116	186° 27' 25"	-12.854	-21.339	-1010416.352571	910869.647106
63-2- 1	47335.668	-70864.439	4.007	138° 05' 06"	-18.003	0.977	46246.947636	1275772.495317
63-2- 2	47332.686	-70861.762	1.174	88° 38' 01"	-2.954	3.851	182278.173786	209325.644948
63-2-10	47332.714	-70860.588	2.867	87° 06' 06"	0.173	4.038	191129.499132	-12258.881724
63-2-11	47332.859	-70857.724	2.873	84° 47' 22"	0.406	5.726	271027.950634	-28768.235944
63-2-12	47333.120	-70854.862	2.868	82° 22' 01"	0.642	5.705	270035.449600	-45488.821404
63-2-13	47333.501	-70852.019	2.872	79° 47' 36"	0.890	5.670	268380.950670	-63058.296910
63-2-14	47334.010	-70849.192	0.635	77° 21' 49"	0.648	3.447	163160.332470	-45910.276416
63-2-60	47334.149	-70848.572	2.826	6° 33' 43"	2.947	0.943	44636.102507	-208790.741684
63-2-59	47336.957	-70848.249	4.549	96° 33' 46"	2.288	4.843	229252.882751	-162100.793712
63-2-58	47336.437	-70843.729	9.737	6° 34' 08"	9.154	5.634	266693.486058	-648503.495266
							倍面積	-635.530236
							面積	317.7651180
							地積	317.76

## 画地面積(座標法)計算簿

画地番号：63- 2-6

点名	Xn	Yn	距離	方向角	X <sub>n+1</sub> -X <sub>n-1</sub>	Y <sub>n+1</sub> -Y <sub>n-1</sub>	X <sub>n</sub> *(Y <sub>n+1</sub> -Y <sub>n-1</sub> )	Y <sub>n</sub> *(X <sub>n+1</sub> -X <sub>n-1</sub> )
63-2-50	47359.630	-70845.323	16.307	276° 20' 51"	12.911	-18.431	-872885.340530	-914683.965253
63-2-52	47361.433	-70861.531	10.811	186° 24' 54"	-8.941	-17.416	-824846.717128	633572.948671
63-2-54	47350.689	-70862.739	19.758	96° 17' 48"	-12.911	18.431	872720.548959	914908.823229
63-2-55	47348.522	-70843.100	11.328	348° 40' 59"	8.941	17.416	824621.859152	-633408.157100
							倍面積	-389.649547
							面積	194.8247735
							地積	194.82