

68街区 画地出来形確認図 (4308.49m²)

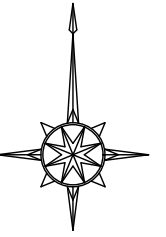

S=1:500

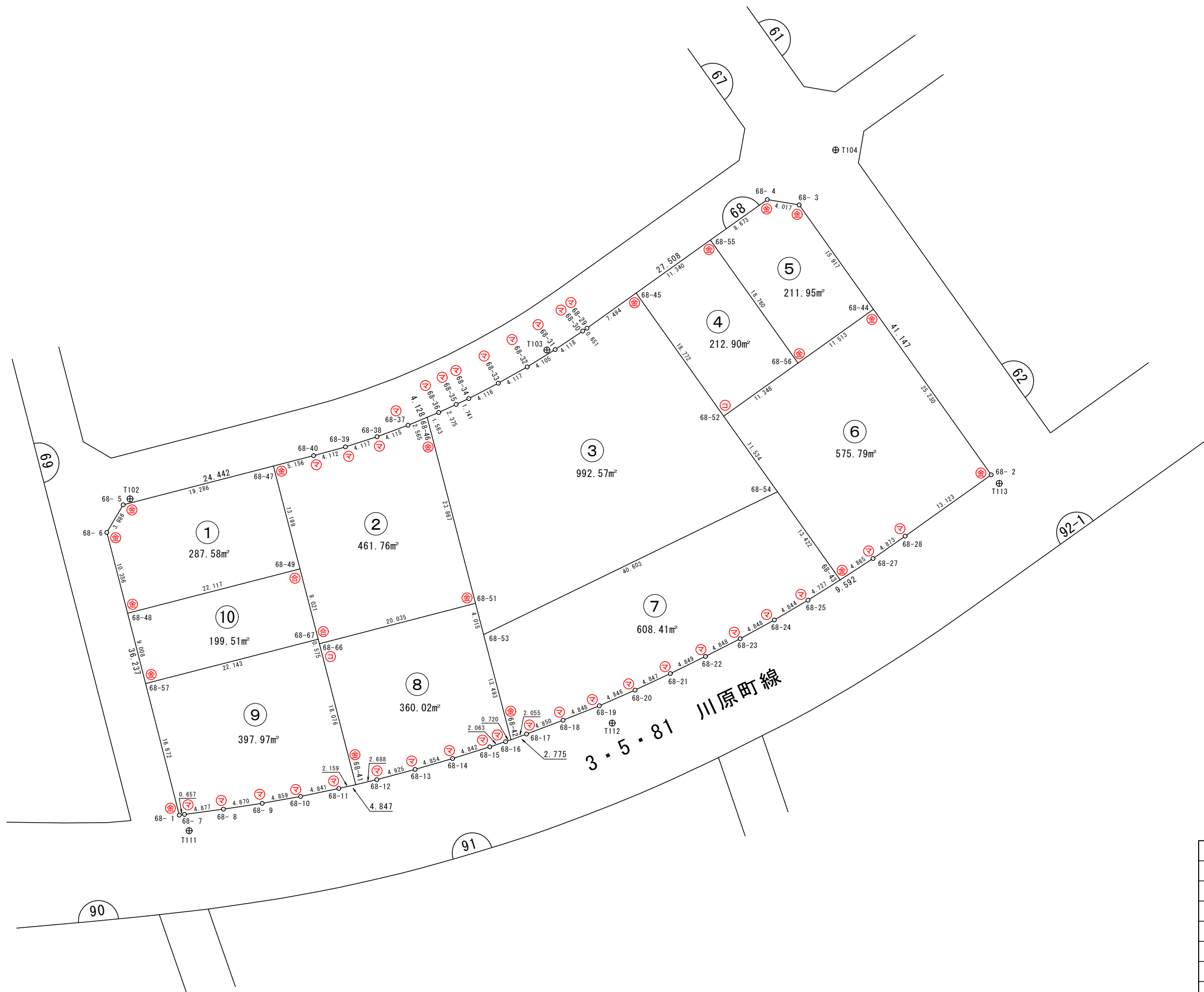

凡 例	
事 項	記 号
金属プレート	⊕
コンクリート杭	⊖
金属釘	⊗
合成樹脂杭	⊕
マーキング	⊗

画地面積(座標法)計算簿

画地番号：68- 1

点名	Xn	Yn	距離	方向角	X _{n+1} -X _{n-1}	Y _{n+1} -Y _{n-1}	X _n *(Y _{n+1} -Y _{n-1})	Y _n *(X _{n+1} -X _{n-1})
68- 5	47237.729	-70813.292	3.986	210° 35' 56"	-8.252	-20.703	-977962.703487	584351.285584
68- 6	47234.298	-70815.321	10.356	165° 33' 26"	-13.460	0.554	26167.801092	953174.220660
68-48	47224.269	-70812.738	22.117	75° 35' 53"	-4.528	24.005	1133618.577345	320640.077664
68-49	47229.770	-70791.316	13.199	345° 30' 47"	18.281	18.120	855803.432400	-1294136.047796
68-47	47242.550	-70794.618	19.286	255° 31' 27"	7.959	-21.976	-1038202.278800	-563454.364662
							倍面積	-575.171450
							面積	287.5857250
							地積	287.58

画地面積(座標法)計算簿

画地番号：68- 2

点名	Xn	Yn	距離	方向角	X _{n+1} -X _{n-1}	Y _{n+1} -Y _{n-1}	X _n *(Y _{n+1} -Y _{n-1})	Y _n *(X _{n+1} -X _{n-1})
68-47	47242.550	-70794.618	13.199	165° 30' 47"	-14.065	-1.692	-79934.394600	995726.302170
68-49	47229.770	-70791.316	9.021	165° 27' 36"	-21.513	5.567	262928.129590	1522933.581108
68-67	47221.037	-70789.051	0.575	165° 11' 26"	-9.289	2.412	113897.141244	657559.494739
68-66	47220.481	-70788.904	20.035	75° 29' 44"	4.462	19.544	922877.080664	-315860.089648
68-51	47225.499	-70769.507	23.867	345° 26' 08"	28.119	13.395	632585.559105	-1989967.767333
68-46	47248.600	-70775.509	2.565	247° 28' 22"	22.118	-8.372	-395565.279200	-1565412.708062
68-37	47247.617	-70777.879	4.115	249° 43' 45"	-2.409	-6.231	-294399.901527	170503.910511
68-38	47246.191	-70781.740	4.117	252° 04' 48"	-2.693	-7.779	-367528.119789	190615.225820
68-39	47244.924	-70785.658	4.112	254° 38' 45"	-2.356	-7.884	-372478.980816	166771.010248
68-40	47243.835	-70789.624	5.156	255° 34' 13"	-2.374	-8.960	-423304.761600	168054.567376
倍面積								-923.526929
面積								461.7634645
地積								461.76

画地面積(座標法)計算簿

画地番号：68- 3

点名	Xn	Yn	距離	方向角	X _{n+1} -X _{n-1}	Y _{n+1} -Y _{n-1}	X _n *(Y _{n+1} -Y _{n-1})	Y _n *(X _{n+1} -X _{n-1})
68-46	47248.600	-70775.509	23.867	165° 26' 08"	-23.709	4.562	215548.113200	1678016.542881
68-51	47225.499	-70769.507	4.015	165° 24' 11"	-26.987	7.014	331239.649986	1909856.685409
68-53	47221.613	-70768.495	40.603	64° 06' 16"	13.847	37.539	1772652.130407	-979931.350265
68-54	47239.346	-70731.968	11.534	324° 32' 56"	27.129	29.837	1409480.366602	-1918887.559872
68-52	47248.742	-70738.658	18.772	324° 32' 56"	24.688	-17.578	-830538.386876	-1746395.988704
68-45	47264.034	-70749.546	7.494	234° 27' 16"	10.935	-16.986	-802826.881524	-773646.285510
68-29	47259.677	-70755.644	0.651	235° 22' 58"	-4.727	-6.634	-313520.697218	334461.929188
68-30	47259.307	-70756.180	4.118	236° 11' 11"	-2.662	-3.958	-187052.337106	188352.951160
68-31	47257.015	-70759.602	4.105	238° 12' 12"	-4.455	-6.911	-326593.230665	315234.026910
68-32	47254.852	-70763.091	4.117	240° 39' 08"	-4.181	-7.078	-334469.842456	295860.483471
68-33	47252.834	-70766.680	4.116	242° 30' 49"	-3.918	-7.241	-342157.770994	277263.852240
68-34	47250.934	-70770.332	1.741	244° 55' 17"	-2.638	-5.229	-247075.133886	186692.135816
68-35	47250.196	-70771.909	2.375	245° 25' 13"	-1.726	-3.737	-176573.982452	122152.314934
68-36	47249.208	-70774.069	1.563	247° 06' 34"	-1.596	-3.600	-170097.148800	112955.414124
							倍面積	-1985.151782
							面積	992.5758910
							地積	992.57

画地面積(座標法)計算簿

画地番号：68- 4

点名	Xn	Yn	距離	方向角	X _{n+1} -X _{n-1}	Y _{n+1} -Y _{n-1}	X _n *(Y _{n+1} -Y _{n-1})	Y _n *(X _{n+1} -X _{n-1})
68-45	47264.034	-70749.546	18.772	144° 32' 56"	-21.870	1.650	77985.656100	1547292.571020
68-52	47248.742	-70738.658	11.348	54° 29' 22"	-8.700	20.126	950928.181492	615426.324600
68-56	47255.334	-70729.420	18.760	324° 31' 27"	21.870	-1.650	-77971.301100	-1546852.415400
68-55	47270.612	-70740.308	11.340	234° 32' 49"	8.700	-20.126	-951368.337112	-615440.679600
							倍面積	-425.800620
							面積	212.9003100
							地積	212.90

画地面積(座標法)計算簿

画地番号：68- 5

点名	Xn	Yn	距離	方向角	$X_{n+1}-X_{n-1}$	$Y_{n+1}-Y_{n-1}$	$X_n*(Y_{n+1}-Y_{n-1})$	$Y_n*(X_{n+1}-X_{n-1})$
68-55	47270.612	-70740.308	18.760	144° 31' 27"	-20.309	3.823	180715.549676	1436664.915172
68-56	47255.334	-70729.420	11.513	54° 32' 15"	-8.598	20.266	957676.598844	608131.553160
68-44	47262.014	-70720.042	15.917	324° 31' 11"	19.642	0.139	6569.419946	-1389083.064964
68- 3	47274.976	-70729.281	4.017	279° 33' 22"	13.629	-13.201	-624076.958176	-963969.370749
68- 4	47275.643	-70733.243	8.673	234° 32' 43"	-4.364	-11.027	-521308.515361	308679.872452
							倍面積	-423.905071
							面積	211.9525355
							地積	211.95

画地面積(座標法)計算簿

画地番号：68- 6

点名	Xn	Yn	距離	方向角	X _{n+1} -X _{n-1}	Y _{n+1} -Y _{n-1}	X _n *(Y _{n+1} -Y _{n-1})	Y _n *(X _{n+1} -X _{n-1})
68-44	47262.014	-70720.042	11.513	234° 32' 15"	13.876	-24.007	-1134619.170098	-981311.302792
68-56	47255.334	-70729.420	11.348	234° 29' 22"	-13.272	-18.616	-879705.297744	938720.862240
68-52	47248.742	-70738.658	11.534	144° 32' 56"	-15.988	-2.548	-120389.794616	1130969.664104
68-54	47239.346	-70731.968	13.422	144° 32' 57"	-20.330	14.475	683789.533350	1437980.909440
68-43	47228.412	-70724.183	4.865	56° 59' 45"	-8.284	11.865	560365.108380	585879.131972
68-27	47231.062	-70720.103	4.873	55° 11' 17"	5.432	8.081	381674.212022	-384151.599496
68-28	47233.844	-70716.102	13.123	54° 32' 13"	10.396	14.690	693865.168360	-735164.596392
68- 2	47241.458	-70705.413	25.230	324° 33' 43"	28.170	-3.940	-186131.344520	-1991771.484210
							倍面積	-1151.584866
							面積	575.7924330
							地積	575.79

画地面積(座標法)計算簿

画地番号：68- 7

点名	Xn	Yn	距離	方向角	X _{n+1} -X _{n-1}	Y _{n+1} -Y _{n-1}	X _n *(Y _{n+1} -Y _{n-1})	Y _n *(X _{n+1} -X _{n-1})
68-43	47228.412	-70724.183	13.422	324° 32' 57"	13.453	-3.784	-178712.311008	-951452.433899
68-54	47239.346	-70731.968	40.603	244° 06' 16"	-6.799	-44.312	-2093269.899952	480906.650432
68-53	47221.613	-70768.495	13.493	165° 22' 47"	-30.790	-33.121	-1564027.044173	2178961.961050
68-42	47208.556	-70765.089	2.055	69° 42' 18"	-12.344	5.334	251810.437704	873524.258616
68-17	47209.269	-70763.161	4.850	69° 16' 56"	2.429	6.465	305207.924085	-171883.718069
68-18	47210.985	-70758.624	4.848	68° 23' 14"	3.502	9.045	427023.359325	-247796.701248
68-19	47212.771	-70754.116	4.846	66° 16' 31"	3.736	8.945	422318.236595	-264337.377376
68-20	47214.721	-70749.679	4.847	64° 54' 16"	4.006	8.827	416764.342267	-283423.214074
68-21	47216.777	-70745.289	4.849	63° 58' 26"	4.184	8.748	413052.365196	-295998.289176
68-22	47218.905	-70740.931	4.848	63° 00' 06"	4.329	8.678	409765.657590	-306237.490299
68-23	47221.106	-70736.611	4.848	61° 17' 19"	4.530	8.572	404779.320632	-320436.847830
68-24	47223.435	-70732.359	4.844	59° 30' 46"	4.787	8.427	397951.886745	-338595.802533
68-25	47225.893	-70728.184	4.727	57° 48' 21"	4.977	8.176	386118.901168	-352014.171768
							倍面積	-1216.823826
							面積	608.4119130
							地積	608.41

画地面積(座標法)計算簿

画地番号：68- 8

点名	Xn	Yn	距離	方向角	X _{n+1} -X _{n-1}	Y _{n+1} -Y _{n-1}	X _n *(Y _{n+1} -Y _{n-1})	Y _n *(X _{n+1} -X _{n-1})
68-42	47208.556	-70765.089	13.493	345° 22' 47"	13.288	-2.724	-128596.106544	-940326.502632
68-53	47221.613	-70768.495	4.015	345° 24' 11"	16.943	-4.418	-208625.086234	-1199030.610785
68-51	47225.499	-70769.507	20.035	255° 29' 44"	-1.132	-20.409	-963825.209091	80111.081924
68-66	47220.481	-70788.904	18.076	165° 31' 35"	-22.521	-14.879	-702593.536799	1594236.906984
68-41	47202.978	-70784.386	2.688	76° 35' 59"	-16.880	7.133	336698.842074	1194840.435680
68-12	47203.601	-70781.771	4.925	75° 05' 01"	1.891	7.375	348126.557375	-133848.328961
68-13	47204.869	-70777.011	4.854	73° 47' 37"	2.623	9.422	444764.275718	-185648.099853
68-14	47206.224	-70772.349	4.842	72° 36' 46"	2.802	9.283	438215.377392	-198304.121898
68-15	47207.671	-70767.728	2.063	71° 31' 16"	2.101	6.578	310532.059838	-148682.996528
68-16	47208.325	-70765.771	0.720	71° 17' 18"	0.885	2.639	124582.769675	-62627.707335
							倍面積	-720.056596
							面積	360.0282980
							地積	360.02

画地面積(座標法)計算簿

画地番号：68- 9

点名	Xn	Yn	距離	方向角	X _{n+1} -X _{n-1}	Y _{n+1} -Y _{n-1}	X _n *(Y _{n+1} -Y _{n-1})	Y _n *(X _{n+1} -X _{n-1})
68-41	47202.978	-70784.386	18.076	345° 31' 35"	17.973	-2.410	-113759.176980	-1272207.769578
68-66	47220.481	-70788.904	0.575	345° 11' 26"	18.059	-4.665	-220283.543865	-1278376.817336
68-67	47221.037	-70789.051	22.143	255° 37' 54"	-4.939	-21.598	-1019879.957126	349627.122889
68-57	47215.542	-70810.502	16.872	165° 38' 18"	-21.840	-17.266	-815223.548172	1546501.363680
68- 1	47199.197	-70806.317	0.657	82° 34' 20"	-16.260	4.837	228302.515889	1151310.714420
68- 7	47199.282	-70805.665	4.877	82° 16' 55"	0.740	5.485	258888.061770	-52396.192100
68- 8	47199.937	-70800.832	4.870	81° 27' 02"	1.379	9.649	455432.192113	-97634.347328
68- 9	47200.661	-70796.016	4.859	79° 54' 48"	1.575	9.600	453126.345600	-111503.725200
68-10	47201.512	-70791.232	4.841	78° 07' 42"	1.847	9.522	449452.797264	-130751.405504
68-11	47202.508	-70786.494	2.159	77° 25' 51"	1.466	6.846	323148.369768	-103773.000204
							倍面積	-795.943739
							面積	397.9718695
							地積	397.97

画地面積(座標法)計算簿

画地番号：68-10

点名	Xn	Yn	距離	方向角	X _{n+1} -X _{n-1}	Y _{n+1} -Y _{n-1}	X _n *(Y _{n+1} -Y _{n-1})	Y _n *(X _{n+1} -X _{n-1})
68-57	47215.542	-70810.502	9.008	345° 37' 45"	3.232	-23.687	-1118394.543354	-228859.542464
68-48	47224.269	-70812.738	22.117	75° 35' 53"	14.228	19.186	906044.825034	-1007523.636264
68-49	47229.770	-70791.316	9.021	165° 27' 36"	-3.232	23.687	1118731.561990	228797.533312
68-67	47221.037	-70789.051	22.143	255° 37' 54"	-14.228	-19.186	-905982.815882	1007186.617628
							倍面積	399.027788
							面積	199.5138940
							地積	199.51