

- 凡例
- 建物以外の工作物
- (自) 自転車置場
  - (倉) 倉庫
  - (吹) 吹き抜けの渡廊下
  - (簡) 簡易な小規模構造物
  - (燃) 燃料庫
  - (照) 照明灯

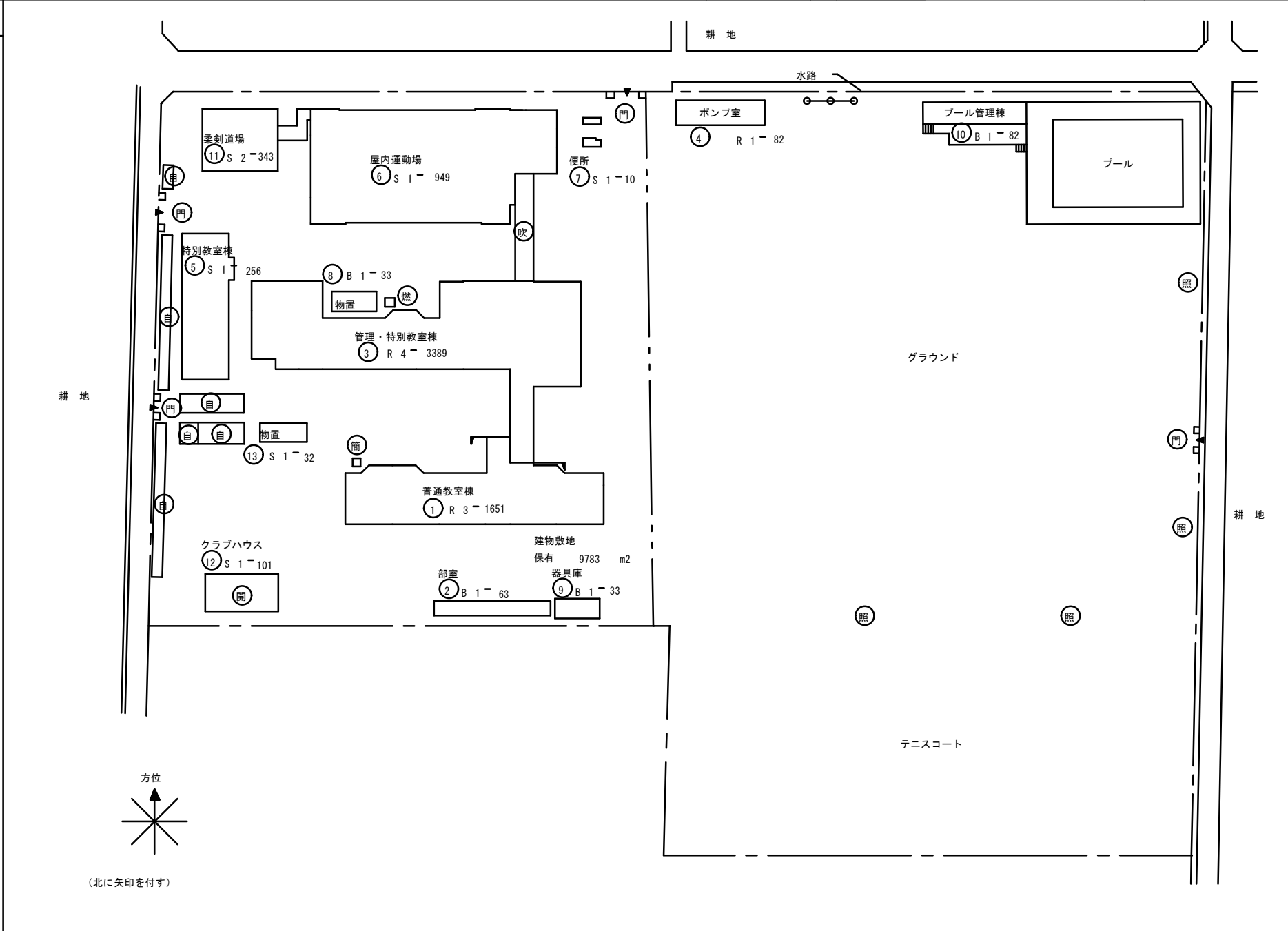

(北に矢印を付す)

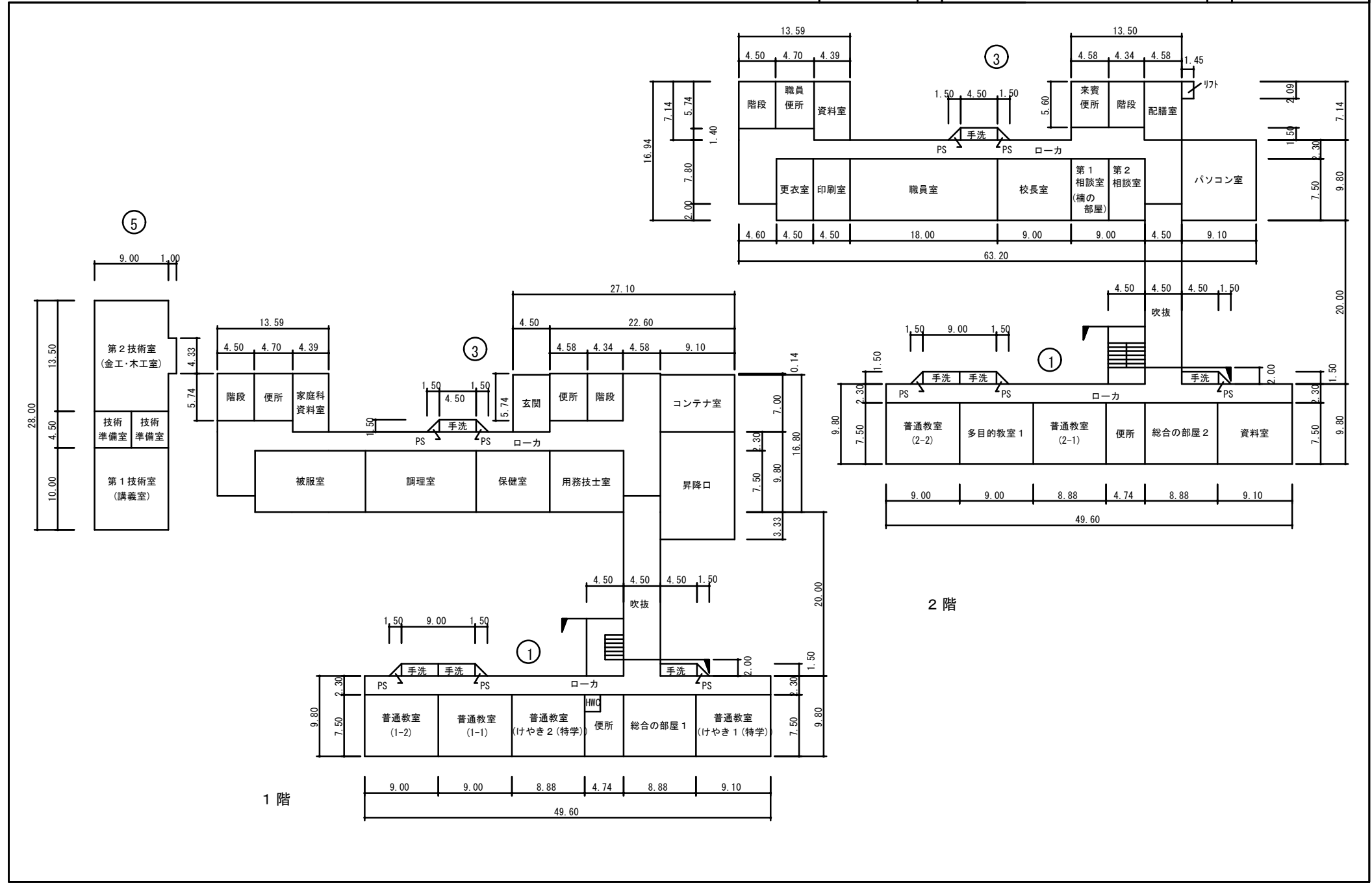
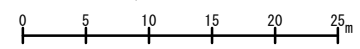

塔屋

③

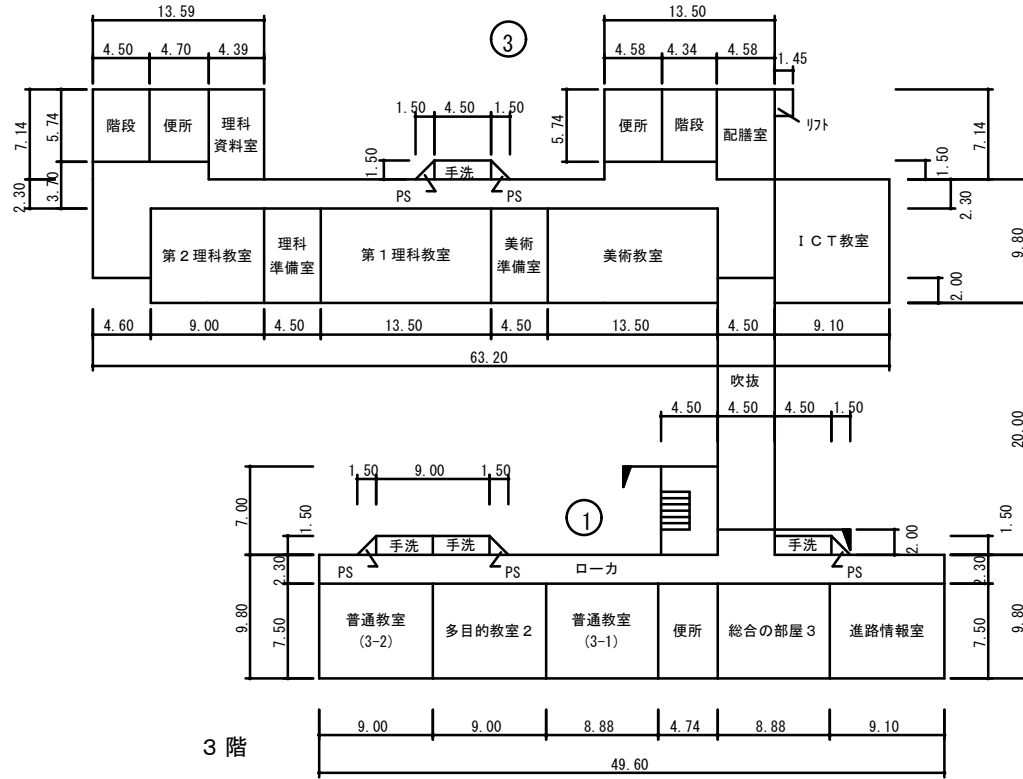
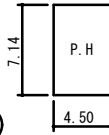

3階

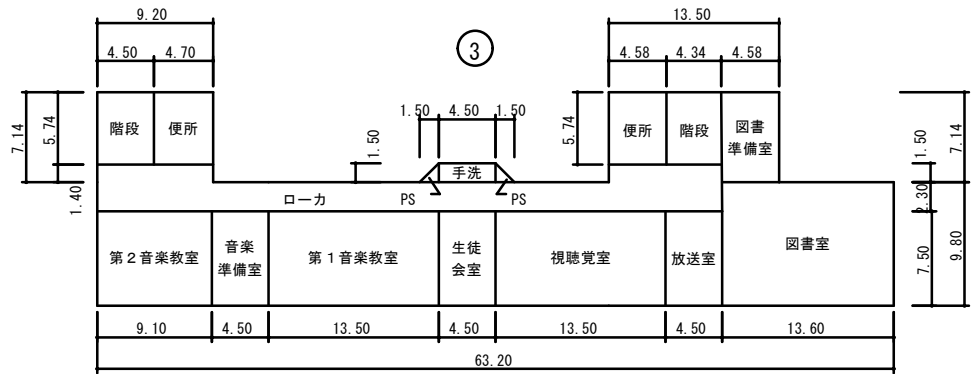

4階

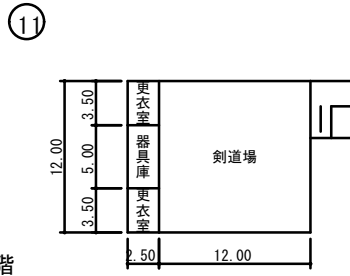
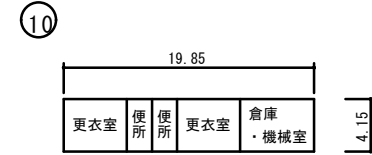
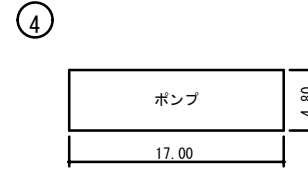
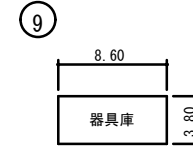
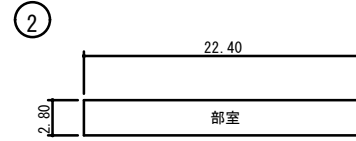
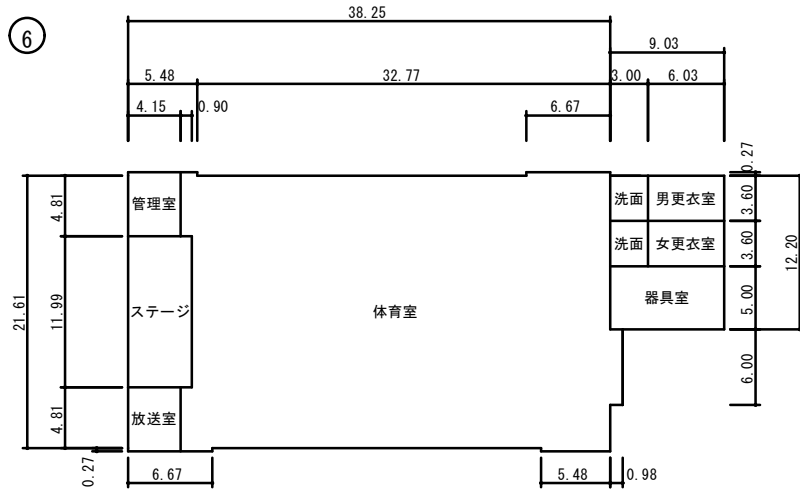

12 クラブハウス (学校開放)

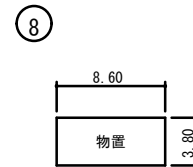
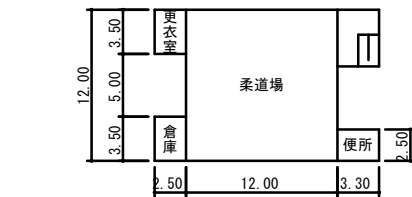
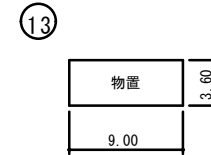
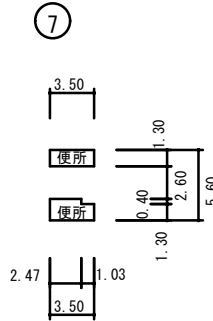
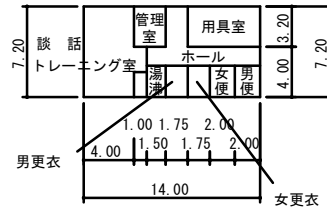

1階